

旭レジデンス 0405

Ready to move in



Property detail



Monthly rent

| | |
|----------------------|-----------|
| Rent | 45,000円 |
| Common fees | — |
| Management fees | — |
| Parking fee | 5,500円／1台 |
| Fixed water fee | 4,400円 |
| Town fee | 600円 |
| Mamex membership fee | 2,970円 |
| Other | — |

Initial costs

| | |
|---------------------|----------------|
| Security deposit | 45,000円 |
| Key money | — |
| Restoration fee | 60,000円 |
| Brokerage fee | 家賃＋駐車料の1か月（税別） |
| Key setting fee | — |
| Internet | — |
| Mamex Admission fee | 13,200円 |
| Other | — |

Property description

| | | | |
|---------------------|--------------------------------|-----------------|-----|
| Location | 金沢市旭町3丁目13番10号 | | |
| Transport | 北鉄バス 旭町バス停/徒歩1分 | | |
| Property type | マンション | Number of Rooms | 25室 |
| Structure | 鉄筋コンクリート造地上6階建 | | |
| Date of completion | 1977年5月 | | |
| Fire insurance | Included in Mamex Members Club | | |
| Guarantor company | Included in Mamex Members Club | | |
| Property category | Managed properties | | |
| Type of transaction | Agency | | |

On-site garbage — / Over 2 stoves / — box / Confirmation of move-in date required / Possible red water due to aging plumbing / Only one air conditioner is guaranteed / This property has been changed to a non-pet property as of August 2024. Please understand that some residents already occupying the property may have pets in accordance with the previous regulations.

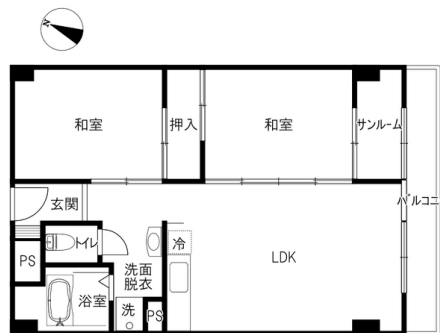

Room layout 和6 和6 LDK12.6（専有面積：58.59㎡）

Rental condition

| | | | |
|------------------|--------------|--------------------|------------------|
| Students only | Women only | Foreigner friendly | Children Allowed |
| 2 people allowed | Pets allowed | | |

Facilities

| | | | |
|---------------------------|--------------------|---------------------|-----------------|
| Free internet | | Wi-Fi routers | |
| Separated bath and toilet | Air conditioning | BS compatible | CATV compatible |
| Balcony | Sunrooms | Bathroom dryer | Indoors washer |
| Independent washbasin | Smart toilet | Gas kitchen | City gas |
| Auto-lock | Card key | CCTV | TV Intercom |
| Delivery box | Lighting equipment | Roofed bicycle park | Car park |

Other facilities

| | |
|----------------|------|
| Carry-on stove | Lift |
|----------------|------|

Morinosato Branch Global Sales Department

金沢市もりの里2丁目21番地 0120-36-3335

免許番号 石川県知事(6)第3529号

手数料負担: 貸主0% 借主100% 手数料配分: 元付50% 客付50%



のうか不動産
NOKA REAL ESTATE