

PENINSULA 0306

2025/ 4/ 13~Move-in ready



Property detail



Monthly rent

Rent	71,000円
Common fees	3,000円
Management fees	
Parking fee	7,700円/1台
Fixed water fee	実費
Town fee	300円
Mamex membership fee	2,970円
Other	—

Initial costs

Security deposit	—
Key money	71,000円
Restoration fee	71,000円
Brokerage fee	家賃+駐車料の1か月(税別)
Key setting fee	16,500円
Internet	11,000円
Mamex Admission fee	13,200円

Other —

Property description

Location	金沢市石引1丁目18番5号		
Transport	北鉄バス 小立野バス停/徒歩3分		
Property type	マンション	Number of Rooms	14室
Structure	鉄骨造地上3階建		
Date of completion	2008年3月		
Fire insurance	Included in Mamex Members Club		
Guarantor company	Included in Mamex Members Club		
Property category	Managed properties		
Type of transaction	Agency		

More than 2 burners on the stove/Kitchen facing each other/open kitchen/Internet Fibre-optic/ShoesBox/top floor/two air-conditioners

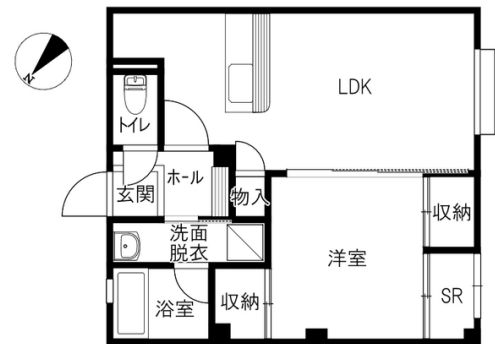

Room layout 洋5 LDK10.1 (専有面積: 37.73㎡)

Rental condition

Students only	Women only	Foreigner friendly	Children Allowed
2 people allowed	Pets allowed	Reservations available before acceptance	

Facilities

Free internet		Wi-Fiルーター付帯可	
Separated bath and toilet	Air conditioning & heating	BS compatible	CATV compatible
Balcony	Sunrooms	Bathroom dryer	Indoors washer
Washbasin	Smart toilet	Gas & IH kitchen	Propane gas
Auto-lock	Card key	CCTV	TV Intercom
Delivery box	Lighting equipment	Roofed bicycle park	Roofed car park

Other facilities

INDUCTION HOB

Morinosato Branch Global Sales Department

金沢市もりの里2丁目21番地 0120-36-3335
 免許番号 石川県知事(6)第3529号
 手数料負担: 貸主0% 借主100% 手数料配分: 元付50% 客付50%

