



Monthly rent

| | | | |
|----------------------|-----------|---------------------|----------------|
| Rent | 78,000円 | Security deposit | — |
| Common fees | | Key money | — |
| Management fees | 3,000円 | | |
| Parking fee | 5,500円／1台 | Restoration fee | 78,000円 |
| Fixed water fee | 実費 | Brokerage fee | 家賃＋駐車料の1か月（税別） |
| Town fee | 200円 | Key setting fee | 16,500円 |
| Mamex membership fee | 2,970円 | Internet | 11,000円 |
| Other | — | Mamex Admission fee | 13,200円 |

Other —

Initial costs

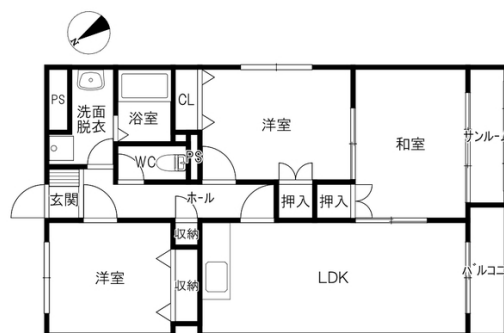

Room layout 和6 洋5.9 洋6 LDK11.3（専有面積：71.4㎡）

Rental condition

| | | | |
|------------------|--------------|--------------------|------------------|
| Students only | Women only | Foreigner friendly | Children Allowed |
| 2 people allowed | Pets allowed | | |

Property description

| | | | |
|---------------------|--------------------------------|-----------------|-----|
| Location | 金沢市もりの里2丁目157番地 | | |
| Transport | 北鉄バス 若松橋バス停/徒歩3分 | | |
| Property type | マンション | Number of Rooms | 25室 |
| Structure | 鉄骨造地上4階建 | | |
| Date of completion | 1997年3月 | | |
| Fire insurance | Included in Mamex Members Club | | |
| Guarantor company | Included in Mamex Members Club | | |
| Property category | Managed properties | | |
| Type of transaction | Agency | | |

On-site garbage station/MORE THAN 2 STOVE TOPS/Internet Fibre-optic/ShoesBox/CORNER ROOM/AIR CONDITIONER WARRANTY ONLY APPLIES TO ONE UNIT INSTALLED IN THE LDK.

Facilities

| | | | |
|---------------------------|--------------------|---------------------|-----------------|
| Free internet | | Wi-Fi — included | |
| Separated bath and toilet | Air conditioning | BS compatible | CATV compatible |
| Balcony | Sunrooms | Bathroom dryer | Indoors washer |
| Independent washbasin | Smart toilet | Gas kitchen | Propane gas |
| Auto-lock | Card key | CCTV | TV Intercom |
| Delivery box | Lighting equipment | Roofed bicycle park | Car park |

Other facilities

| | |
|----------------|--------------------|
| Carry-on stove | Reheating function |
|----------------|--------------------|

Morinosato Branch Global Sales Department

金沢市もりの里2丁目21番地 0120-36-3335

免許番号 石川県知事(6)第3529号

手数料負担:貸主0% 借主100% 手数料配分:元付50% 客付50%

