

## ラ・グランダム ドウ 0203

2025/ 4/ 13~Move-in ready



Property detail



写真準備中

## Monthly rent

Rent	54,000円
Common fees Management fees	3,000円
Parking fee	5,500円/1台
Fixed water fee	実費
Town fee	300円
Mamex membership fee	2,970円
Other	—

## Initial costs

Security deposit	—
Key money	—
Restoration fee	60,000円
Brokerage fee	家賃+駐車料の1か月(税別)
Key setting fee	16,500円
Internet	11,000円
Mamex Admission fee	13,200円
Other	—

## Property description

Location	金沢市旭町1丁目16番30号		
Transport	北鉄バス 旭町一丁目バス停/徒歩4分		
Property type	マンション	Number of Rooms	12室
Structure	鉄筋コンクリート造地上3階建		
Date of completion	2005年3月		
Fire insurance	Included in Mamex Members Club		
Guarantor company	Included in Mamex Members Club		
Property category	Managed properties		
Type of transaction	Agency		

On-site garbage station/ 2 OR MORE STOVE TOPS / Internet Fibre-optic / ShoesBox / P2 ¥3,300

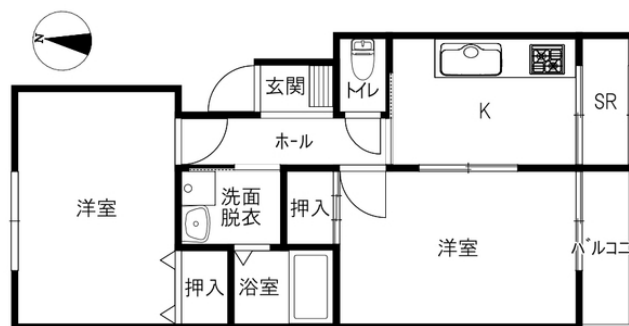

Room layout 洋7 洋7 K4.6 (専有面積: 42.24㎡)

## Rental condition

Students only	Women only	Foreigner friendly	Children Allowed
2 people allowed	Pets allowed	Available for spring move-in	Reservations available before acceptance

## Facilities

Free internet		Bring-your-own Wi-Fi router	
Separated bath and toilet	Air conditioning	BS compatible	CATV compatible
Balcony	Sunrooms	Bathroom dryer	Indoors washer
Washbasin	Smart toilet	Gas kitchen	Propane gas
Auto-lock	Card key	CCTV	TV Intercom
Delivery box	Lighting equipment	Roofed bicycle park	Car park

## Other facilities

Gas stove	Trunk room
-----------	------------

Morinosato Branch Global Sales Department

金沢市もりの里2丁目21番地 0120-36-3335  
 免許番号 石川県知事(6)第3529号  
 手数料負担: 貸主0% 借主100% 手数料配分: 元付50% 客付50%

