

写真準備中

Monthly rent

Rent	56,000円	Security deposit	—
Common fees		Key money	—
Management fees	3,000円		
Parking fee	5,500円／1台	Restoration fee	60,000円
Fixed water fee	実費	Brokerage fee	家賃＋駐車料の1か月（税別）
Town fee	150円	Key setting fee	19,800円
Mamex membership fee	3,300円	Internet	11,000円
Other	—	Mamex Admission fee	24,200円

Other

Property description

Location	金沢市もりの里1丁目226番地		
Transport	北鉄バス 若松西バス停/徒歩6分		
Property type	マンション	Number of Rooms	7室
Structure	鉄骨造地上3階建		
Date of completion	1997年3月		
Fire insurance	Included in Mamex Members Club		
Guarantor company	Included in Mamex Members Club		
Property category	Managed properties		
Type of transaction	Agency		

More than 2 burners on stove / — light / — box / Corner room / Top floor / P roof 6,600 yen (tax included) / Guaranteed 1 air conditioner (between Flooring with — room)

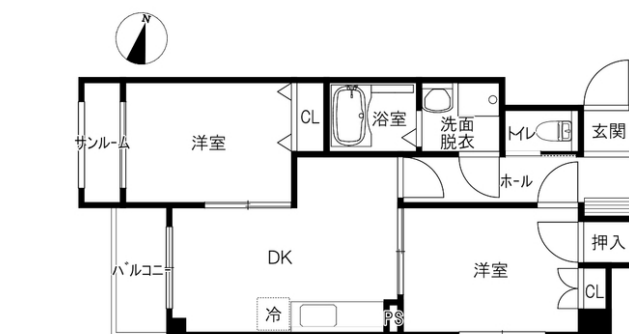

Room layout 洋5.6 洋5 DK8.1（専有面積：46.8㎡）

Rental condition

Students only	Women only	Foreigner friendly	Children Allowed
2 people allowed	Pets allowed	Available for spring move-in	Reservations available before acceptance

Facilities

Free internet		Wi-Fi — included	
Separated bath and toilet	Air conditioning	BS compatible	CATV compatible
Balcony	Sunrooms	Bathroom dryer	Indoors washer
Independent washbasin	Smart toilet	Gas kitchen	Propane gas
Auto-lock	IC KEY	CCTV	TV Intercom
Delivery box	Lighting equipment	Roofed bicycle park	Roofed car park

Other facilities

Carry-on stove

Morinosato Branch Global Sales Department

金沢市もりの里2丁目21番地 0120-36-3335

免許番号 石川県知事(6)第3529号

手数料負担: 貸主0% 借主100% 手数料配分: 元付50% 客付50%

