

## Monthly rent

|                                |           |                        |                    |
|--------------------------------|-----------|------------------------|--------------------|
| Rent                           | 60,000円   | Security deposit       | —                  |
| Common fees<br>Management fees | 5,000円    | Key money              | —                  |
| Parking fee                    | 7,700円／1台 | Restoration fee        | 60,000円            |
| Fixed water fee                | 3,850円    | Brokerage fee          | 家賃＋駐車料の<br>1か月（税別） |
| Town fee                       | 500円      | Key setting fee        | 19,800円            |
| Mamex<br>membership fee        | 3,300円    | Internet               | 11,000円            |
| Other                          | —         | Mamex<br>Admission fee | 24,200円            |

## Initial costs

Other —

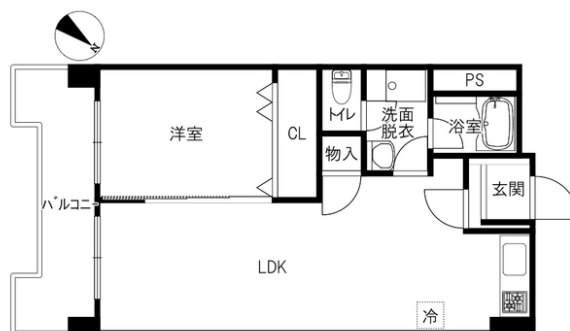

## Room layout

洋6 LDK15.5（専有面積：46.9㎡）

## Rental condition

|                  |              |                              |  |
|------------------|--------------|------------------------------|--|
| Students only    | Women only   | Foreigner friendly           | Children Allowed                         |
| 2 people allowed | Pets allowed | Available for spring move-in | Reservations available before acceptance |

## Property description

|                     |                                |                 |     |
|---------------------|--------------------------------|-----------------|-----|
| Location            | 金沢市西念2丁目1番39号                  |                 |     |
| Transport           | JR北陸新幹線 金沢駅/徒歩12分              |                 |     |
| Property type       | マンション                          | Number of Rooms | 23室 |
| Structure           | 鉄筋コンクリート造地上7階建                 |                 |     |
| Date of completion  | 1979年6月                        |                 |     |
| Fire insurance      | Included in Mamex Members Club |                 |     |
| Guarantor company   | Included in Mamex Members Club |                 |     |
| Property category   | Managed properties             |                 |     |
| Type of transaction | Agency                         |                 |     |

敷地内ゴミステーション／コンロ2口以上／システムキッチン／インターネット光／室内物干し／最上階／エアコン2基／1人入居の場合は水道料定額2,750円/月

## Facilities

|                           |                    |                     |                 |
|---------------------------|--------------------|---------------------|-----------------|
| Free internet             |                    | Wi-Fi — included    |                 |
| Separated bath and toilet | Air conditioning   | BS compatible       | CATV compatible |
| Balcony                   | Sunrooms           | Bathroom dryer      | Indoors washer  |
| Independent washbasin     | Smart toilet       | Gas kitchen         | City gas        |
| Auto-lock                 | Card key           | CCTV                | TV Intercom     |
| Delivery box              | Lighting equipment | Roofed bicycle park | Car park        |

## Other facilities

|           |      |
|-----------|------|
| Gas stove | Lift |
|-----------|------|

Morinosato Branch Global Sales  
Department

金沢市もりの里2丁目21番地 0120-36-3335

免許番号 石川県知事(6)第3529号

手数料負担: 貸主0% 借主100% 手数料配分: 元付50% 客付50%

