



## Monthly rent

Rent	71,000円	Security deposit	—
Common fees		Key money	—
Management fees	5,000円		
Parking fee	8,800円／1台	Restoration fee	71,000円
Fixed water fee	実費	Brokerage fee	家賃＋駐車料の1か月（税別）
Town fee	300円	Key setting fee	19,800円
Mamex membership fee	3,300円	Internet	11,000円
Other	—	Mamex Admission fee	24,200円

## Initial costs

Other —

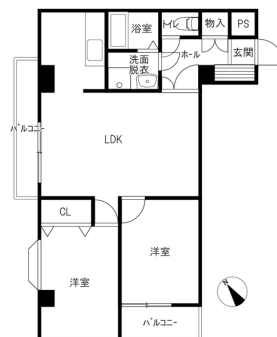

## Room layout

洋6.5 洋6 LDK16.2（専有面積：60.75㎡）

## Rental condition

Students only	Women only	Foreigner friendly	Children Allowed
2 people allowed	Pets allowed	Available for spring move-in	Reservations available before acceptance

## Property description

Location	金沢市駅西本町2丁目12番22号		
Transport	北鉄バス 西念南バス停/徒歩2分		
Property type	マンション	Number of Rooms	30室
Structure	鉄骨造地上7階建		
Date of completion	1987年3月		
Fire insurance	Included in Mamex Members Club		
Guarantor company	Included in Mamex Members Club		
Property category	Managed properties		
Type of transaction	Agency		

On-site garbage — / Over 2 burner stove / System kitchen / — access / — box / Pets are allowed (deposit of 1 month's rent is required in case of keeping pets) / — cannot be unlocked from inside Rooms.

## Facilities

Free internet		Wi-Fi — included	
Separated bath and toilet	Air conditioning	BS compatible	CATV compatible
Balcony	Sunrooms	Bathroom dryer	Indoors washer
Washbasin	Smart toilet	Gas & IH kitchen	City gas
Auto-lock	Card key	CCTV	TV Intercom
Delivery box	Lighting equipment	Roofed bicycle park	Car park

## Other facilities

INDUCTION HOB	Lift
---------------	------

Morinosato Branch Global Sales Department

金沢市もりの里2丁目21番地 0120-36-3335

免許番号 石川県知事(6)第3529号

手数料負担: 貸主0% 借主100% 手数料配分: 元付50% 客付50%

