

プラウド若松 0101

2025/ 4/ 6-Move-in ready



Property detail



Monthly rent

Rent	35,000円
Common fees Management fees	2,000円
Parking fee	2,200円/1台
Fixed water fee	実費
Town fee	300円
Mamex membership fee	2,970円
Other	—

Initial costs

Security deposit	35,000円
Key money	—
Restoration fee	60,000円
Brokerage fee	家賃+駐車料の1か月(税別)
Key setting fee	16,500円
Internet	—
Mamex Admission fee	13,200円
Other	—

Property description

Location	金沢市若松町93番地		
Transport	北鉄バス 若松バス停/徒歩3分		
Property type	アパート	Number of Rooms	6室
Structure	木造地上2階建		
Date of completion	1986年10月		
Fire insurance	Included in Mamex Members Club		
Guarantor company	Included in Mamex Members Club		
Property category	Managed properties		
Type of transaction	Agency		

More than 2 stove tops / Roomsinside drying / sh —zubox / corner room

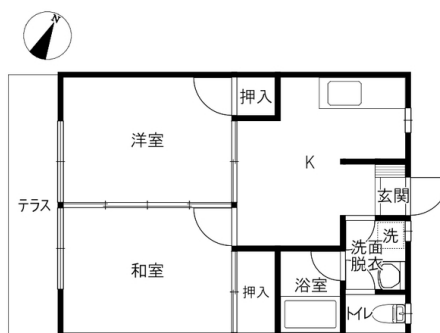

Room layout 和6 洋6 K4.5 (専有面積: 39.31㎡)

Rental condition

Students only	Women only	Foreigner friendly	Children Allowed
2 people allowed	Pets allowed	Available for spring move-in	Reservations available before acceptance

Facilities

Free internet	Wi-Fi routers		
Separated bath and toilet	Air conditioning	BS compatible	CATV compatible
Terrace	Sunrooms	Bathroom dryer	Indoors washer
Independent washbasin	Smart toilet	Gas kitchen	Propane gas
Auto-lock	Card key	CCTV	TV Intercom
Delivery box	Lighting equipment	Roofed bicycle park	Car park

Other facilities

Carry-on stove

Morinosato Branch Global Sales Department

金沢市もりの里2丁目21番地 0120-36-3335
 免許番号 石川県知事(6)第3529号
 手数料負担: 貸主0% 借主100% 手数料配分: 元付50% 客付50%

