

ペルシェ四十万 0101

2025/ 3/ 13~Move-in ready



Property detail



Monthly rent

Rent	36,000円
Common fees Management fees	3,000円
Parking fee	3,300円/1台
Fixed water fee	実費
Town fee	650円
Mamex membership fee	2,970円
Other	—

Initial costs

Security deposit	—
Key money	—
Restoration fee	60,000円
Brokerage fee	家賃+駐車料の1か月(税別)
Key setting fee	16,500円
Internet	11,000円
Mamex Admission fee	13,200円
Other	—

Property description

Location	金沢市四十万3丁目139番地		
Transport	北鉄バス 中四十万バス停/徒歩8分		
Property type	アパート	Number of Rooms	8室
Structure	木造地上2階建		
Date of completion	1988年6月		
Fire insurance	Included in Mamex Members Club		
Guarantor company	Included in Mamex Members Club		
Property category	Managed properties		
Type of transaction	Agency		

コンロ2口以上/インターネット光/角部屋/浄水器不可/ペットの飼育は可とする。(2匹まで、大型犬不可)/ペット飼育時は賃料1ヶ月分の敷金有

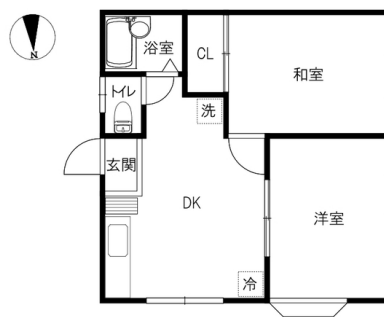

Room layout 洋6 和6 DK8.5 (専有面積: 40.57㎡)

Rental condition

Students only	Women only	Foreigner friendly	Children Allowed
2 people allowed	Pets allowed	Available for spring move-in	Reservations available before acceptance

Facilities

Free internet		Bring-your-own Wi-Fi router	
Separated bath and toilet	Air conditioning	BS compatible	CATV compatible
Balcony	Sunrooms	Bathroom dryer	Indoors washer
Washbasin In bathroom	Smart toilet	Gas kitchen	Propane gas
Auto-lock	Card key	CCTV	TV Intercom
Delivery box	Lighting equipment	Roofed bicycle park	Car park

Other facilities

Carry-on stove

Morinosato Branch Global Sales Department

金沢市もりの里2丁目21番地 0120-36-3335
免許番号 石川県知事(6)第3529号
手数料負担: 貸主0% 借主100% 手数料配分: 元付50% 客付50%

