

尾張町マンション 0402

Ready to move in



Property detail



Monthly rent

Rent	138,000円
Common fees	
Management fees	5,000円
Parking fee	7,000円/1台
Fixed water fee	実費
Town fee	320円
Mamex membership fee	2,970円
Other	—

Initial costs

Security deposit	—
Key money	—
Restoration fee	138,000円
Brokerage fee	家賃+駐車料の1か月(税別)
Key setting fee	11,000円
Internet	—
Mamex Admission fee	13,200円
Other	—

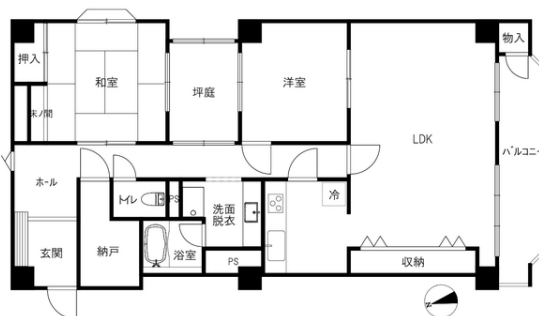

Room layout

LDK24 洋7.5 和8 (専有面積: 108.97㎡)

Rental condition

Students only	Women only	Foreigner friendly	Children Allowed
2 people allowed	Pets allowed		

Facilities

Free internet	Wi-Fi routers		
Separated bath and toilet	Air conditioning	BS compatible	CATV compatible
Balcony	Sunrooms	Bathroom dryer	Indoors washer
Independent washbasin	Smart toilet	IH kitchen	Propane gas
Auto-lock	Card key	CCTV	TV Intercom
Delivery box	Lighting equipment	Roofed bicycle park	Roofed car park

Other facilities

INDUCTION HOB	Lift	Trunk room
---------------	------	------------

Property description

Location	金沢市尾張町1丁目2番36号		
Transport	北鉄バス 尾張町バス停/徒歩4分		
Property type	マンション	Number of Rooms	29室
Structure	鉄骨鉄筋コンクリート造地上9階建		
Date of completion	1980年9月		
Fire insurance	Included in Mamex Members Club		
Guarantor company	Included in Mamex Members Club		
Property category	Managed properties		
Type of transaction	Agency		

MOTORCYCLE PARKING SPACE / GARBAGE — ON THE PREMISES / OVER 2 BURNER STOVE / SYSTEM KITCHEN / DISH WASHER/DRYER / — BOX / NO WATER PURIFIER / ONE AC UNIT INSTALLED (LDK) / FAN — AVAILABLE (EXTRA COST REQUIRED) / NO SMOKING IN THE ROOMS / — CONDOMINIUM TYPE COMPATIBLE (NTT FLET'S HIKARI)) INDIVIDUAL CONTRACT REQUIRED / TATAMI MATS WILL BE CHANGED AS SOON AS THE CONTRACT IS FINALIZED / MOTORBIKE PARKING (RENT DIFFERS DEPENDING ON THE COMPARTMENT) / GAS AND WATER FEES ARE TO BE PAID TO GOHINSHA.

Morinosato Branch Global Sales
Department

金沢市もりの里2丁目21番地 0120-36-3335

免許番号 石川県知事(6)第3529号

手数料負担: 貸主0% 借主100% 手数料配分: 元付50% 客付50%



のうか不動産
NOKA REAL ESTATE