



Park side M 0205

during move-in

Property detail



Monthly rent

Rent	—	Security deposit	—
Common fees	—	Key money	—
Management fees	—	Restoration fee	—
Parking fee	—	Brokerage fee	—
Fixed water fee	—	Key setting fee	—
Town fee	—	Internet	—
Mamex membership fee	3,300円	Mamex Admission fee	24,200円
Other	—	Other	—

Initial costs

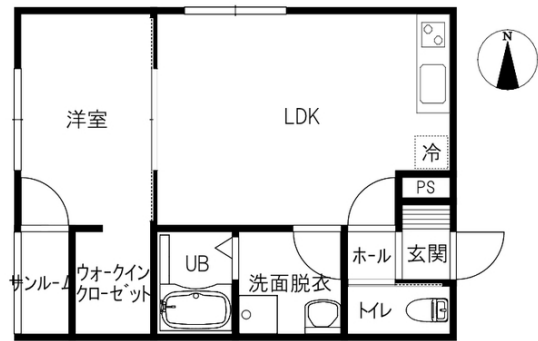

Room layout

洋5 LDK10.6 (専有面積: 40.16㎡)

Rental condition

Students only	Women only	Foreigner friendly	Children Allowed
2 people allowed	Pets allowed		

Property description

Location	野々市市押越1丁目154番地		
Transport	北鉄バス 太平寺バス停/徒歩9分		
Property type	アパート	Number of Rooms	10室
Structure	木造地上2階建		
Date of completion	2025年1月		
Fire insurance	Included in Mamex Members Club		
Guarantor company	Included in Mamex Members Club		
Property category	Managed properties		
Type of transaction	Agency		

Facilities

Free internet		Wi-Fi — included	
Separated bath and toilet	Air conditioning	BS compatible	CATV compatible
Balcony	Sunrooms	Bathroom dryer/heater	Indoors washer
Washbasin	Smart toilet	IH kitchen	Propane gas
Auto-lock	IC KEY	CCTV	TV Intercom
Delivery box	Lighting equipment	Roofed bicycle park	Car park

Other facilities

INDUCTION HOB

Morinosato Branch Global Sales
Department

金沢市もりの里2丁目21番地 0120-36-3335
免許番号 石川県知事(6)第3529号
手数料負担: 貸主0% 借主100% 手数料配分: 元付50% 客付50%

のうか不動産
NOKA REAL ESTATE

On-site — 2-burner stove or larger / Open-concept kitchen / — / — / Corner unit / Top floor / Water purifiers not permitted / Water bill: 4,000 yen + tax for two occupants