



写真準備中

Monthly rent

| | | | |
|----------------------|--------|---------------------|---------|
| Rent | — | Security deposit | — |
| Common fees | — | Key money | — |
| Management fees | — | Restoration fee | — |
| Parking fee | — | Brokerage fee | — |
| Fixed water fee | — | Key setting fee | — |
| Town fee | — | Internet | — |
| Mamex membership fee | 2,970円 | Mamex Admission fee | 13,200円 |
| Other | — | Other | — |

Initial costs

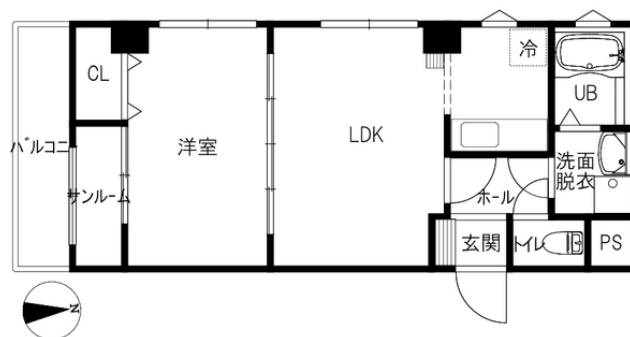

Room layout 洋6.6 LDK10.2 (専有面積: 41㎡)

Property description

| | | | |
|---------------------|--------------------------------|-----------------|-----|
| Location | 金沢市増泉3丁目13番14号 | | |
| Transport | IRいしかわ鉄道 西金沢駅/徒歩23分 | | |
| Property type | アパート | Number of Rooms | 17室 |
| Structure | 鉄筋コンクリート造地上3階建 | | |
| Date of completion | 2006年3月 | | |
| Fire insurance | Included in Mamex Members Club | | |
| Guarantor company | Included in Mamex Members Club | | |
| Property category | Managed properties | | |
| Type of transaction | Agency | | |

敷地内ゴミステーション/コンロ2口以上/対面キッチン/インターネット光/シューズボックス/角部屋/最上階/AC1基備付/IHコンセントは30A250V用

Rental condition

| | | | |
|------------------|--------------|--------------------|------------------|
| Students only | Women only | Foreigner friendly | Children Allowed |
| 2 people allowed | Pets allowed | | |

Facilities

| Free internet | | Bring-your-own Wi-Fi router | |
|---------------------------|----------------------------|-----------------------------|---------------------------|
| Separated bath and toilet | Air conditioning & heating | BS compatible | CATV compatible |
| Balcony | Sunrooms | Bathroom dryer | place for washing machine |
| Independent washbasin | Smart toilet | Gas & IH kitchen | Propane gas |
| Auto-lock | Card key | CCTV | TV Intercom |
| Delivery box | Lighting equipment | Roofed bicycle park | Car park |

Other facilities

| | |
|----------------|--|
| Carry-on stove | |
|----------------|--|

Morinosato Branch Global Sales Department

金沢市もりの里2丁目21番地 0120-36-3335

免許番号 石川県知事(6)第3529号

手数料負担: 貸主0% 借主100% 手数料配分: 元付50% 客付50%

のうか不動産
NOKA REAL ESTATE