



Monthly rent

| | | | |
|--------------------------------|-----------|---------------------|----------------|
| Rent | 55,000円 | Security deposit | — |
| Common fees Management fees | 3,000円 | Key money | — |
| Parking fee | 5,500円/1台 | Restoration fee | 55,000円 |
| Fixed water fee | 実費 | Brokerage fee | 家賃+駐車料の1か月(税別) |
| Town fee | 300円 | Key setting fee | 16,500円 |
| Mamex membership fee | 3,300円 | Internet | — |
| Other | — | Mamex Admission fee | 24,200円 |

Initial costs

| | |
|---------------------|----------------|
| Security deposit | — |
| Key money | — |
| Restoration fee | 55,000円 |
| Brokerage fee | 家賃+駐車料の1か月(税別) |
| Key setting fee | 16,500円 |
| Internet | — |
| Mamex Admission fee | 24,200円 |
| Other | — |

Property description

| | | | |
|---------------------|--------------------------------|-----------------|-----|
| Location | 金沢市増泉3丁目13番14号 | | |
| Transport | IRいしかわ鉄道 西金沢駅/徒歩23分 | | |
| Property type | アパート | Number of Rooms | 17室 |
| Structure | 鉄筋コンクリート造地上3階建 | | |
| Date of completion | 2006年3月 | | |
| Fire insurance | Included in Mamex Members Club | | |
| Guarantor company | Included in Mamex Members Club | | |
| Property category | Managed properties | | |
| Type of transaction | Agency | | |

敷地内ゴミステーション/コンロ2口以上/対面キッチン/ガスヒーター利用可/インターネット光/シューズボックス/角部屋/最上階/AC2基備付とする。/IHコンセントは30A250V用

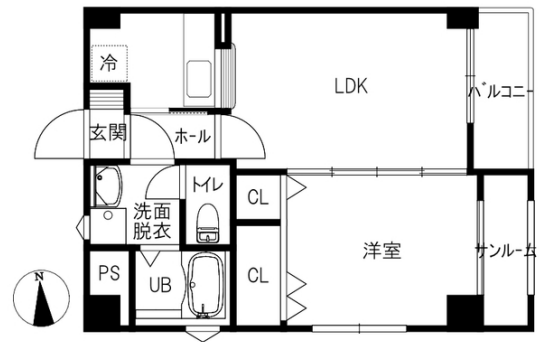

Room layout

洋5.9 LDK10.4 (専有面積: 41.8㎡)

Rental condition

| | | | |
|------------------|--------------|--------------------|------------------|
| Students only | Women only | Foreigner friendly | Children Allowed |
| 2 people allowed | Pets allowed | | |

Facilities

| | | | |
|---------------------------|--------------------|-----------------------------|---------------------------|
| Free internet | | Bring-your-own Wi-Fi router | |
| Separated bath and toilet | Air conditioning | BS compatible | CATV compatible |
| Balcony | Sunrooms | Bathroom dryer | place for washing machine |
| Independent washbasin | Smart toilet | Gas & IH kitchen | Propane gas |
| Auto-lock | Card key | CCTV | TV Intercom |
| Delivery box | Lighting equipment | Roofed bicycle park | Car park |

Other facilities

Carry-on stove

Morinosato Branch Global Sales Department

金沢市もりの里2丁目21番地 0120-36-3335
 免許番号 石川県知事(6)第3529号
 手数料負担: 貸主0% 借主100% 手数料配分: 元付50% 客付50%

