

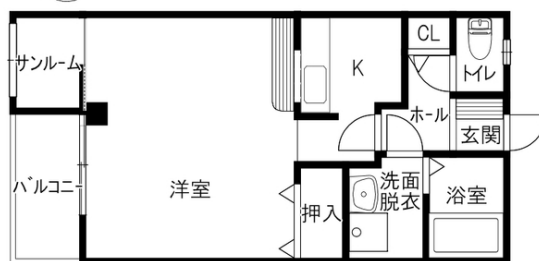

Monthly rent

Rent	—	Security deposit	—
Common fees	—	Key money	—
Management fees	—	Restoration fee	—
Parking fee	—	Brokerage fee	—
Fixed water fee	—	Key setting fee	—
Town fee	—	Internet	—
Mamex membership fee	2,970円	Mamex Admission fee	13,200円
Other	—	Other	—

Initial costs



Room layout

洋9.4 K (専有面積：36.54㎡)

Rental condition

Students only	Women only	Foreigner friendly	Children Allowed
Single Apartment	Pets allowed	Available for spring move-in	Reservations available before acceptance

Property description

Location	金沢市もりの里1丁目240番地		
Transport	北鉄バス 若松西バス停/徒歩8分		
Property type	マンション	Number of Rooms	28室
Structure	鉄骨造地上4階建		
Date of completion	2000年3月		
Fire insurance	Included in Mamex Members Club		
Guarantor company	Included in Mamex Members Club		
Property category	Managed properties		
Type of transaction	Agency		

On-site garbage station/More than 2 stove tops/Facing kitchen/Internet Fibre-optic/ShoesBox/Corner room

Facilities

Free internet		Wi-Fi — included	
Separated bath and toilet	Air conditioning	BS compatible	CATV compatible
Balcony	Sunrooms	Bathroom dryer	Indoors washer
Independent washbasin	Smart toilet	Gas kitchen	Propane gas
Auto-lock	Card key	CCTV	TV Intercom
Delivery box	Lighting equipment	Roofed bicycle park	Roofed car park

Other facilities

Carry-on stove

Morinosato Branch Global Sales Department

金沢市もりの里2丁目21番地 0120-36-3335

免許番号 石川県知事(6)第3529号

手数料負担:貸主0% 借主100% 手数料配分:元付50% 客付50%



のうか不動産
NOKA REAL ESTATE