

ロフト天神 0101

2026/ 5/ 17~Move-in ready



Property detail



写真準備中

Monthly rent

| | |
|--------------------------------|---------|
| Rent | 24,000円 |
| Common fees Management fees | 2,000円 |
| Parking fee | — |
| Fixed water fee | 実費 |
| Town fee | 200円 |
| Mamex membership fee | 3,300円 |
| Other | — |

Initial costs

| | |
|------------------------|---------------------|
| Security deposit | — |
| Key money | — |
| Restoration fee | 50,000円 |
| Brokerage fee | 家賃+駐車料の 1か月 (税別) |
| Key setting fee | 19,800円 |
| Internet | 11,000円 |
| Mamex Admission fee | 24,200円 |
| Other | — |

Property description

| | | | |
|---------------------|--------------------------------|-----------------|----|
| Location | 金沢市天神町2丁目19番24号 | | |
| Transport | 北鉄バス 桜町バス停/徒歩5分 | | |
| Property type | アパート | Number of Rooms | 4室 |
| Structure | 木造地上2階建 | | |
| Date of completion | 1990年2月 | | |
| Fire insurance | Included in Mamex Members Club | | |
| Guarantor company | Included in Mamex Members Club | | |
| Property category | Managed properties | | |
| Type of transaction | Agency | | |

Internet Fibre-optic / corner room

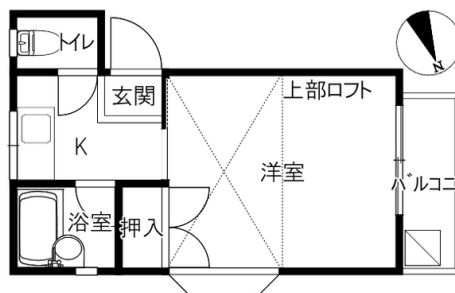

Room layout 洋7 K2 ロフト (専有面積: 20.27㎡)

Rental condition

| | | | |
|------------------|--------------|--------------------|------------------|
| Students only | Women only | Foreigner friendly | Children Allowed |
| Single Apartment | Pets allowed | | |

Facilities

| | | | |
|---------------------------|--------------------|---------------------|-------------------------|
| Free internet | | Wi-Fi — included | |
| Separated bath and toilet | Air conditioning | BS compatible | CATV compatible |
| Balcony | Sunrooms | Bathroom dryer | Washing machine outdoor |
| Washbasin In bathroom | Smart toilet | Gas & IH kitchen | Propane gas |
| Auto-lock | Card key | CCTV | TV Intercom |
| Delivery box | Lighting equipment | Roofed bicycle park | Car park |

Other facilities

INDUCTION HOB

Morinosato Branch Global Sales
Department金沢市もりの里2丁目21番地 0120-36-3335
免許番号 石川県知事(6)第3529号
手数料負担: 貸主0% 借主100% 手数料配分: 元付50% 客付50%

 のうか不動産
 NOKA REAL ESTATE