



フレンズ90 0103

2026/ 3/ 10~Move-in ready



写真準備中

Monthly rent

| | |
|----------------------|-----------|
| Rent | 32,000円 |
| Common fees | 2,000円 |
| Management fees | |
| Parking fee | 3,300円/1台 |
| Fixed water fee | 実費 |
| Town fee | 100円 |
| Mamex membership fee | 3,300円 |
| Other | — |

Initial costs

| | |
|---------------------|----------------|
| Security deposit | — |
| Key money | — |
| Restoration fee | 50,000円 |
| Brokerage fee | 家賃+駐車料の1か月(税別) |
| Key setting fee | 19,800円 |
| Internet | 11,000円 |
| Mamex Admission fee | 24,200円 |
| Other | — |

Property description

| | | | |
|---------------------|--------------------------------|-----------------|----|
| Location | 金沢市田上2丁目137番地 | | |
| Transport | 北鉄バス 田上新町バス停/徒歩3分 | | |
| Property type | アパート | Number of Rooms | 8室 |
| Structure | 木造地上2階建 | | |
| Date of completion | 1990年11月 | | |
| Fire insurance | Included in Mamex Members Club | | |
| Guarantor company | Included in Mamex Members Club | | |
| Property category | Managed properties | | |
| Type of transaction | Agency | | |

At least 2 stoves/Internet Fibre-optic/ShoesBox

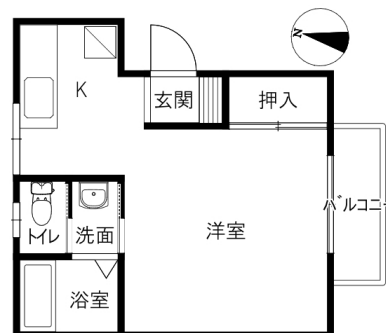

Room layout 洋8 K2.5 (専有面積: 26.5㎡)

Rental condition

| | | | |
|------------------|--------------|------------------------------|--|
| Students only | Women only | Foreigner friendly | Children Allowed |
| Single Apartment | Pets allowed | Available for spring move-in | Reservations available before acceptance |

Facilities

| | | | |
|---------------------------|--------------------|---------------------|-----------------|
| Free internet | | Wi-Fi — included | |
| Separated bath and toilet | Air conditioning | BS compatible | CATV compatible |
| Balcony | Sunrooms | Bathroom dryer | Indoors washer |
| Independent washbasin | Smart toilet | Gas & IH kitchen | Propane gas |
| Auto-lock | Card key | CCTV | TV Intercom |
| Delivery box | Lighting equipment | Roofed bicycle park | Car park |

Other facilities

Carry-on stove

Morinosato Branch Global Sales Department

金沢市もりの里2丁目21番地 0120-36-3335

免許番号 石川県知事(6)第3529号

手数料負担: 貸主0% 借主100% 手数料配分: 元付50% 客付50%

のうか不動産
NOKA REAL ESTATE