



Monthly rent

Rent	34,000円	Security deposit	—
Common fees		Key money	—
Management fees	2,000円		
Parking fee	3,300円／1台	Restoration fee	50,000円
Fixed water fee	実費	Brokerage fee	家賃＋駐車料の1か月（税別）
Town fee	100円	Key setting fee	16,500円
Mamex membership fee	2,970円	Internet	11,000円
Other	—	Mamex Admission fee	13,200円

Other —

Initial costs

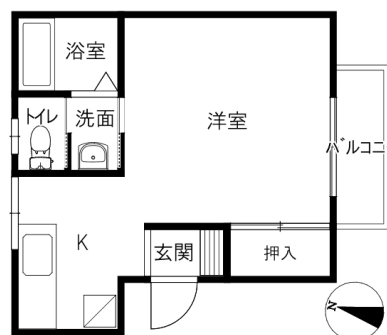

Room layout

洋8 K2.5（専有面積：26.5㎡）

Rental condition

Students only	Women only	Foreigner friendly	Children Allowed
Single Apartment	Pets allowed		

Property description

Location	金沢市田上2丁目137番地		
Transport	北鉄バス 田上新町バス停/徒歩3分		
Property type	アパート	Number of Rooms	8室
Structure	木造地上2階建		
Date of completion	1990年11月		
Fire insurance	Included in Mamex Members Club		
Guarantor company	Included in Mamex Members Club		
Property category	Managed properties		
Type of transaction	Agency		

Facilities

Free internet		Wi-Fi — included	
Separated bath and toilet	Air conditioning	BS compatible	CATV compatible
Balcony	Sunrooms	Bathroom dryer	Indoors washer
Washbasin	Smart toilet	Gas & IH kitchen	Propane gas
Auto-lock	Card key	CCTV	TV Intercom
Delivery box	Lighting equipment	Roofed bicycle park	Car park

Other facilities

Carry-on stove

Morinosato Branch Global Sales Department

金沢市もりの里2丁目21番地 0120-36-3335

免許番号 石川県知事(6)第3529号

手数料負担: 貸主0% 借主100% 手数料配分: 元付50% 客付50%



のうか不動産
NOKA REAL ESTATE

More than 2 stoves/Internet Fibre-optic/ShoesBox/top floor