

## ゼフィール森の里 0203

Closed



Property detail



写真準備中

## Monthly rent

|                      |        |                     |         |
|----------------------|--------|---------------------|---------|
| Rent                 | —      | Security deposit    | —       |
| Common fees          | —      | Key money           | —       |
| Management fees      | —      | Restoration fee     | —       |
| Parking fee          | —      | Brokerage fee       | —       |
| Fixed water fee      | —      | Key setting fee     | —       |
| Town fee             | —      | Internet            | —       |
| Mamex membership fee | 2,970円 | Mamex Admission fee | 13,200円 |
| Other                | —      | Other               | —       |

## Initial costs

## Property description

|                     |                                |                 |     |
|---------------------|--------------------------------|-----------------|-----|
| Location            | 金沢市もりの里1丁目216番地                |                 |     |
| Transport           | 北鉄バス 若松西バス停/徒歩5分               |                 |     |
| Property type       | マンション                          | Number of Rooms | 14室 |
| Structure           | 鉄筋コンクリート造地上3階建                 |                 |     |
| Date of completion  | 2004年3月                        |                 |     |
| Fire insurance      | Included in Mamex Members Club |                 |     |
| Guarantor company   | Included in Mamex Members Club |                 |     |
| Property category   | Managed properties             |                 |     |
| Type of transaction | Agency                         |                 |     |

More than 2 burners on stove/Inter-Net optical/ Corner room/ Clothes dryer

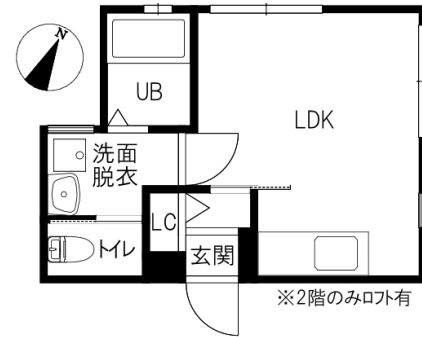

Room layout 洋8.2 ロフト (専有面積: 26.53㎡)

## Rental condition

|                  |              |                              |  |
|------------------|--------------|------------------------------|--|
| Students only    | Women only   | Foreigner friendly           | Children Allowed                         |
| Single Apartment | Pets allowed | Available for spring move-in | Reservations available before acceptance |

## Facilities

|                           |                    |                             |                 |
|---------------------------|--------------------|-----------------------------|-----------------|
| Free internet             |                    | Bring-your-own Wi-Fi router |                 |
| Separated bath and toilet | Air conditioning   | BS compatible               | CATV compatible |
| Balcony                   | Sunrooms           | Bathroom dryer              | Indoors washer  |
| Independent washbasin     | Smart toilet       | Gas kitchen                 | Propane gas     |
| Auto-lock                 | Card key           | CCTV                        | TV Intercom     |
| Delivery box              | Lighting equipment | Roofed bicycle park         | Car park        |

## Other facilities

Carry-on stove

Morinosato Branch Global Sales Department

金沢市もりの里2丁目21番地 0120-36-3335

免許番号 石川県知事(6)第3529号

手数料負担: 貸主0% 借主100% 手数料配分: 元付50% 客付50%

のうか不動産  
NOKA REAL ESTATE