



### Monthly rent

Rent	40,000円
Common fees Management fees	2,000円
Parking fee	—
Fixed water fee	実費
Town fee	200円
Mamex membership fee	2,970円
Other	—

### Initial costs

Security deposit	—
Key money	—
Restoration fee	50,000円
Brokerage fee	家賃＋駐車料の 1か月（税別）
Key setting fee	16,500円
Internet	11,000円
Mamex Admission fee	13,200円

Other

### Property description

Location	金沢市もりの里1丁目216番地		
Transport	北鉄バス 若松西バス停/徒歩5分		
Property type	マンション	Number of Rooms	14室
Structure	鉄筋コンクリート造地上3階建		
Date of completion	2004年3月		
Fire insurance	Included in Mamex Members Club		
Guarantor company	Included in Mamex Members Club		
Property category	Managed properties		
Type of transaction	Agency		

More than 2 burners on stove/Internet Fibre-optic/ Top floor/  
Clothes dryer

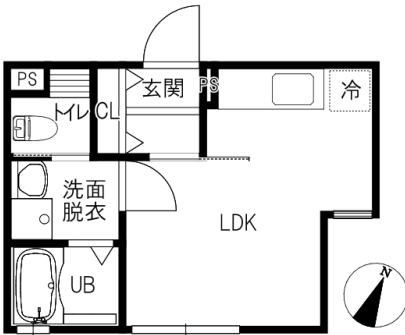

### Room layout

洋8.1（専有面積：21.58㎡）

### Rental condition

Students only	Women only	Foreigner friendly	Children Allowed
Single Apartment	Pets allowed	Available for spring move-in	Reservations available before acceptance

### Facilities

Free internet		Wi-Fi — included	
Separated bath and toilet	Air conditioning	BS compatible	CATV compatible
Balcony	Sunrooms	Bathroom dryer	Indoors washer
Independent washbasin	Smart toilet	Gas kitchen	Propane gas
Auto-lock	Card key	CCTV	TV Intercom
Delivery box	Lighting equipment	Roofed bicycle park	Car park

### Other facilities

Carry-on stove

Morinosato Branch Global Sales  
Department

金沢市もりの里2丁目21番地 0120-36-3335  
免許番号 石川県知事(6)第3529号  
手数料負担:貸主0% 借主100% 手数料配分:元付50% 客付50%

