

パレス藤堂 0102

Ready to move in



Property detail



Monthly rent

Rent	34,000円	Security deposit	—
Common fees		Key money	—
Management fees	2,000円		
Parking fee	無料／1台	Restoration fee	50,000円
Fixed water fee	実費	Brokerage fee	家賃＋駐車料の1か月（税別）
Town fee	—	Key setting fee	16,500円
Mamex membership fee	2,970円	Internet	11,000円
Other	—	Mamex Admission fee	13,200円

Other —

Property description

Location	金沢市田上2丁目85番地		
Transport	北鉄バス 田上新町バス停/徒歩3分		
Property type	アパート	Number of Rooms	7室
Structure	木造地上2階建		
Date of completion	1992年3月		
Fire insurance	Included in Mamex Members Club		
Guarantor company	Included in Mamex Members Club		
Property category	Managed properties		
Type of transaction	Agency		

Internet Fibre-optic/Shoebox

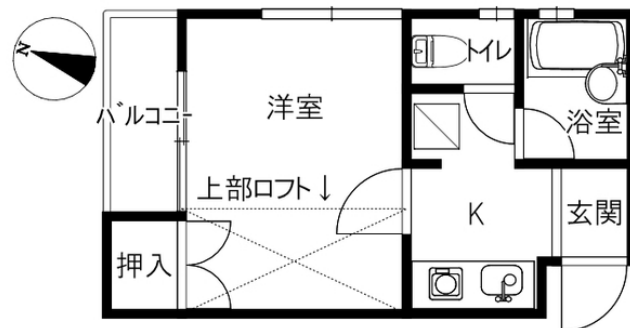

Room layout 洋6 K2 ロフト（専有面積：20.26㎡）

Rental condition

Students only	Women only	Foreigner friendly	Children Allowed
Single Apartment	Pets allowed		

Facilities

Free internet		Wi-Fi — included	
Separated bath and toilet	Air conditioning	BS compatible	CATV compatible
Balcony	Sunrooms	Bathroom dryer	Indoors washer
Washbasin In bathroom	heated toilet seat	IH kitchen	Propane gas
Auto-lock	Card key	CCTV	TV Intercom
Delivery box	Lighting equipment	Roofed bicycle park	Car park

Other facilities

INDUCTION HOB

Morinosato Branch Global Sales Department

金沢市もりの里2丁目21番地 0120-36-3335

免許番号 石川県知事(6)第3529号

手数料負担:貸主0% 借主100% 手数料配分:元付50% 客付50%

のうか不動産
NOKA REAL ESTATE