

# パレス藤堂 0203

Closed



Property detail



写真準備中

## Monthly rent

Rent	—	Security deposit	—
Common fees Management fees	—	Key money	—
Parking fee	—	Restoration fee	—
Fixed water fee	—	Brokerage fee	—
Town fee	—	Key setting fee	—
Mamex membership fee	Student: 2,970円 Worker: 2,090円	Internet	—
Other	—	Mamex Admission fee	Student: 13,200円 Worker: 11,000円
		Other	—

## Property description

Location	金沢市田上2丁目85番地		
Transport	北鉄バス 田上新町バス停/徒歩3分		
Property type	アパート	Number of Rooms	7室
Structure	木造地上2階建		
Date of completion	1992年3月		
Fire insurance	Included in Mamex Members Club		
Guarantor company	Included in Mamex Members Club		
Property category	Managed properties		
Type of transaction	Agency		

Internet Fibre-optic/Shoebox

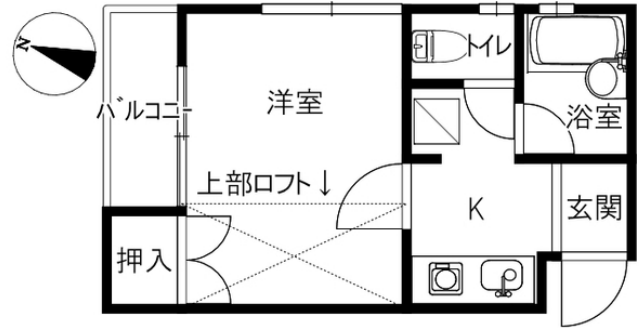

Room layout 洋6 K2 ロフト (専有面積: 20.26㎡)

## Rental condition

Students only	Male / Female	Foreigner friendly	Children Allowed
Single Apartment	Pets allowed	Available for spring move-in	Reservations available before acceptance

## Facilities

Free internet		Bring-your-own Wi-Fi router	
Separated bath and toilet	Air conditioning	BS compatible	CATV compatible
Balcony	Sunrooms	Bathroom dryer	Indoors washer
Washbasin In bathroom	heated toilet seat	IH kitchen	Propane gas
Auto-lock	Card key	CCTV	TV Intercom
Delivery box	Lighting equipment	Roofed bicycle park	Car park

## Other facilities

INDUCTION HOB

Morinosato Branch Global Sales  
Department

金沢市もりの里2丁目21番地 0120-36-3335  
免許番号 石川県知事(6)第3529号  
手数料負担: 貸主0% 借主100% 手数料配分: 元付50% 客付50%

のうか不動産  
NOKA REAL ESTATE