



## Monthly rent

Rent	—	Security deposit	—
Common fees Management fees	—	Key money	—
Parking fee	—	Restoration fee	—
Fixed water fee	—	Brokerage fee	—
Town fee	—	Key setting fee	—
Mamex membership fee	3,300円	Internet	—
Other	—	Mamex Admission fee	24,200円
		Other	—

## Initial costs

## Property description

Location	金沢市若松町南25番地		
Transport	北鉄バス 若松バス停/徒歩3分		
Property type	マンション	Number of Rooms	15室
Structure	鉄筋コンクリート造地上3階建		
Date of completion	1995年3月		
Fire insurance	Included in Mamex Members Club		
Guarantor company	Included in Mamex Members Club		
Property category	Managed properties		
Type of transaction	Agency		

Internet Fibre-optic/ShoesBox/corner room

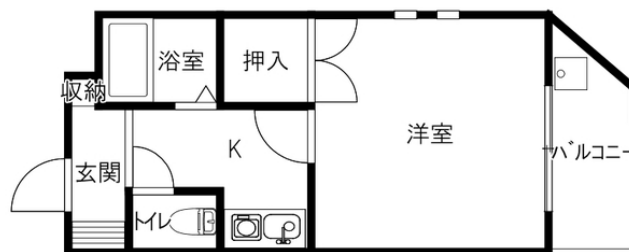

Room layout 洋7.4 K2 (専有面積: 24.5㎡)

## Rental condition

Students only	Women only	Foreigner friendly	Children Allowed
Single Apartment	Pets allowed		

## Facilities

Free internet		Wi-Fi — included	
Separated bath and toilet	Air conditioning	BS compatible	CATV compatible
Balcony	Sunrooms	Bathroom dryer	Washing machine outdoor
Washbasin	Smart toilet	IH kitchen	City gas
Auto-lock	Card key	CCTV	TV Intercom
Delivery box	Lighting equipment	Roofed bicycle park	Car park

## Other facilities

INDUCTION HOB	Trunk room
---------------	------------

Morinosato Branch Global Sales Department

金沢市もりの里2丁目21番地 0120-36-3335  
 免許番号 石川県知事(6)第3529号  
 手数料負担: 貸主0% 借主100% 手数料配分: 元付50% 客付50%

