

# プルミエハイム 0110

Ready to move in



Property detail



## Monthly rent

Rent	38,000円	Security deposit	—
Common fees	2,000円	Key money	38,000円
Management fees		Restoration fee	50,000円
Parking fee	6,600円/1台	Brokerage fee	家賃+駐車料の1か月(税別)
Fixed water fee	実費	Key setting fee	19,800円
Town fee	—	Internet	11,000円
Mamex membership fee	3,300円	Mamex Admission fee	24,200円
Other	—	Other	—

## Initial costs

## Property description

Location	金沢市もりの里2丁目153番地		
Transport	北鉄バス 若松西バス停/徒歩1分		
Property type	マンション	Number of Rooms	35室
Structure	鉄骨造地上3階建		
Date of completion	1993年3月		
Fire insurance	Included in Mamex Members Club		
Guarantor company	Included in Mamex Members Club		
Property category	Managed properties		
Type of transaction	Agency		

— / — / — (Valid only for move-ins by the end of May; a penalty equal to one month's rent will apply if the lease is terminated before one year has elapsed)

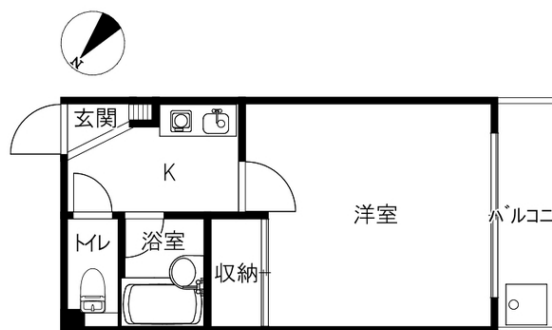

## Room layout

洋8 K2 (専有面積: 24.01㎡)

## Rental condition

Students only	Women only	Foreigner friendly	Children Allowed
Single Apartment	Pets allowed		

## Facilities

Free internet		Wi-Fi — included	
Separated bath and toilet	Air conditioning	BS compatible	CATV compatible
Balcony	Sunrooms	Bathroom dryer/heater	Washing machine outdoor
Washbasin In bathroom	Smart toilet	IH kitchen	City gas
Auto-lock	Card key	CCTV	TV Intercom
Delivery box	Lighting equipment	Roofed bicycle park	Car park

## Other facilities

INDUCTION HOB

Morinosato Branch Global Sales Department

金沢市もりの里2丁目21番地 0120-36-3335  
 免許番号 石川県知事(6)第3529号  
 手数料負担: 貸主0% 借主100% 手数料配分: 元付50% 客付50%

