

Monthly rent

| | | | |
|----------------------|---------|---------------------|----------------|
| Rent | 51,000円 | Security deposit | — |
| Common fees | | Key money | 51,000円 |
| Management fees | 2,000円 | Restoration fee | 51,000円 |
| Parking fee | — | Brokerage fee | 家賃+駐車料の1か月（税別） |
| Fixed water fee | 実費 | Key setting fee | 16,500円 |
| Town fee | 200円 | Internet | 11,000円 |
| Mamex membership fee | 2,970円 | Mamex Admission fee | 13,200円 |
| Other | — | Other | — |

Initial costs

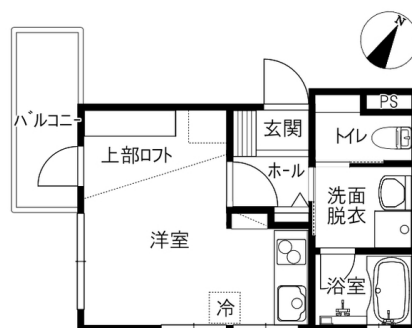

Room layout

洋8 ロフト（専有面積：23.62㎡）

Rental condition

| | | | |
|------------------|--------------|--------------------|------------------|
| Students only | Women only | Foreigner friendly | Children Allowed |
| Single Apartment | Pets allowed | | |

Property description

| | | | |
|---------------------|--------------------------------|-----------------|-----|
| Location | 金沢市もりの里2丁目219番地 | | |
| Transport | 北鉄バス 鈴見町バス停/徒歩1分 | | |
| Property type | マンション | Number of Rooms | 13室 |
| Structure | 鉄筋コンクリート造地上3階建 | | |
| Date of completion | 2007年3月 | | |
| Fire insurance | Included in Mamex Members Club | | |
| Guarantor company | Included in Mamex Members Club | | |
| Property category | Managed properties | | |
| Type of transaction | Agency | | |

More than 2 burners on stove/ System kitchen/ Internet Fibre-optic/ RoomsInside drying/ ShoesBox/ Corner room/ Top floor

Facilities

| | | | |
|---------------------------|----------------------------|---------------------|-----------------|
| Free internet | | Wi-Fi — included | |
| Separated bath and toilet | Air conditioning & heating | BS compatible | CATV compatible |
| Balcony | Sunrooms | Bathroom dryer | Indoors washer |
| Washbasin | Smart toilet | IH kitchen | Propane gas |
| Auto-lock | Card key | CCTV | TV Intercom |
| Delivery box | Lighting equipment | Roofed bicycle park | Car park |

Other facilities

INDUCTION HOB

Morinosato Branch Global Sales Department

金沢市もりの里2丁目21番地 0120-36-3335

免許番号 石川県知事(6)第3529号

手数料負担: 貸主0% 借主100% 手数料配分: 元付50% 客付50%

