

アイビービレッジ 0202

Closed



Property detail



写真準備中

Monthly rent

| | | | |
|--------------------------------|--------|---------------------|---------|
| Rent | — | Security deposit | — |
| Common fees Management fees | — | Key money | — |
| Parking fee | — | Restoration fee | — |
| Fixed water fee | — | Brokerage fee | — |
| Town fee | — | Key setting fee | — |
| Mamex membership fee | 2,970円 | Internet | — |
| Other | — | Mamex Admission fee | 13,200円 |

Initial costs

Other —

Property description

| | | | |
|---------------------|--------------------------------|-----------------|-----|
| Location | 金沢市旭町3丁目18番6号 | | |
| Transport | 北鉄バス 旭町バス停/徒歩2分 | | |
| Property type | マンション | Number of Rooms | 30室 |
| Structure | 鉄筋コンクリート造地上4階建 | | |
| Date of completion | 2009年1月 | | |
| Fire insurance | Included in Mamex Members Club | | |
| Guarantor company | Included in Mamex Members Club | | |
| Property category | Managed properties | | |
| Type of transaction | Agency | | |

On-site garbage station / 2 or more stove tops / System kitchen / Internet Fibre-optic / ShoesBox

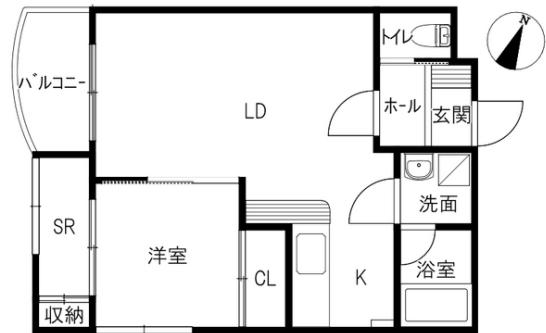

Room layout 洋4.2 LDK12.2 (専有面積: 40.72㎡)

Rental condition

| | | | |
|------------------|---------------|------------------------------|--|
| Students only | Male / Female | Foreigner friendly | Children Allowed |
| Single Apartment | Pets allowed | Available for spring move-in | Reservations available before acceptance |

Facilities

| | | | |
|---------------------------|----------------------------|-----------------------------|-----------------|
| Free internet | | Bring-your-own Wi-Fi router | |
| Separated bath and toilet | Air conditioning & heating | BS compatible | CATV compatible |
| Balcony | Sunrooms | Bathroom dryer | Indoors washer |
| Washbasin | Smart toilet | IH kitchen | Propane gas |
| Auto-lock | Card key | CCTV | TV Intercom |
| Delivery box | Lighting equipment | Roofed bicycle park | Car park |

Other facilities

INDUCTION HOB

Morinosato Branch Global Sales Department

金沢市もりの里2丁目21番地 0120-36-3335

免許番号 石川県知事(6)第3529号

手数料負担: 貸主0% 借主100% 手数料配分: 元付50% 客付50%

のうか不動産
NOKA REAL ESTATE