

## Charmant Craft 0101

2026/ 9/ 2~Move-in ready



Property detail



## Monthly rent

Rent	55,000円
Common fees Management fees	3,000円
Parking fee	5,500円/1台
Fixed water fee	実費
Town fee	400円
Mamex membership fee	3,300円
Other	—

## Initial costs

Security deposit	55,000円
Key money	110,000円
Restoration fee	55,000円
Brokerage fee	家賃+駐車料の 1か月 (税別)
Key setting fee	19,800円
Internet	11,000円
Mamex Admission fee	24,200円

Other

—

## Property description

Location	金沢市田上の里2丁目285番地		
Transport	北鉄バス 若松バス停/徒歩7分		
Property type	マンション	Number of Rooms	28室
Structure	鉄筋コンクリート造地上4階建		
Date of completion	2009年3月		
Fire insurance	Included in Mamex Members Club		
Guarantor company	Included in Mamex Members Club		
Property category	Managed properties		
Type of transaction	Agency		

On-site — 2-burner stove or larger / — / — available / — / — cabinet

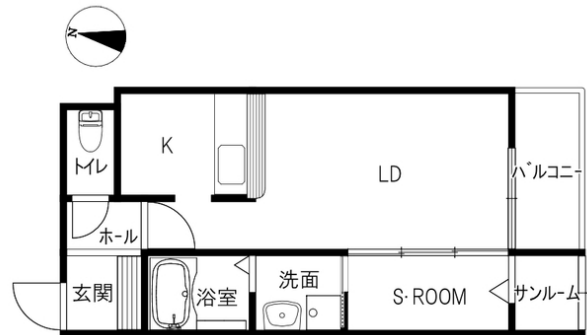

## Room layout

洋8.1 K2.3 サービスルーム (専有面積: 32.21㎡)

## Rental condition

Students only	Women only	Foreigner friendly	Children Allowed
Single Apartment	Pets allowed		

## Facilities

Free internet		Wi-Fi — included	
Separated bath and toilet	Air conditioning	BS compatible	CATV compatible
Terrace	Sunrooms	Bathroom dryer	Indoors washer
Washbasin	Smart toilet	IH kitchen	Propane gas
Auto-lock	Card key	CCTV	TV Intercom
Delivery box	Lighting equipment	Roofed bicycle park	Car park

## Other facilities

INDUCTION HOB	Trunk room
---------------	------------

Morinosato Branch Global Sales Department

金沢市もりの里2丁目21番地 0120-36-3335  
 免許番号 石川県知事(6)第3529号  
 手数料負担: 貸主0% 借主100% 手数料配分: 元付50% 客付50%

