



R·NANCHI 0205

2025/ 4/ 1~Move-in ready



Property detail



写真準備中

Monthly rent

Rent	48,000円
Common fees Management fees	3,000円
Parking fee	6,600円/1台
Fixed water fee	実費
Town fee	—
Mamex membership fee	Student: 2,970円 Worker: 2,090円
Other	—

Initial costs

Security deposit	—
Key money	—
Restoration fee	50,000円
Brokerage fee	家賃+駐車料の 1か月 (税別)
Key setting fee	11,000円
Internet	—
Mamex Admission fee	Student: 13,200円 Worker: 11,000円
Other	—

Property description

Location	金沢市もりの里2丁目147番地		
Transport	北鉄バス 若松橋バス停/徒歩3分		
Property type	マンション	Number of Rooms	48室
Structure	鉄骨造地上6階建		
Date of completion	2005年2月		
Fire insurance	Included in Mamex Members Club		
Guarantor company	Included in Mamex Members Club		
Property category	Managed properties		
Type of transaction	Agency		

On-site garbage station SHION/DISPOSAL —THE —/Internet Fibre-optic/ShoesBox/P WITHOUT ROOF 5,500 YEN (TAX INCLUDED)

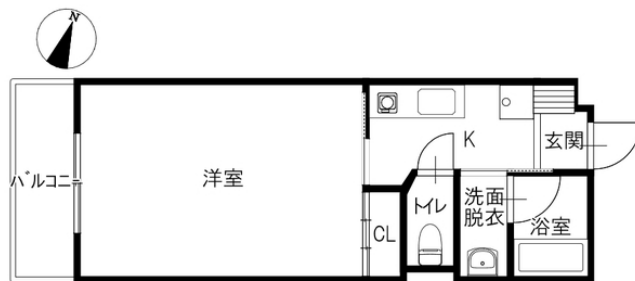

Room layout 洋9.1 K3

Exclusive area 27.01㎡

Rental condition

Students only	Male / Female	Foreigner friendly	Children Allowed	Single Apartment	Pets allowed
---------------	---------------	--------------------	------------------	------------------	--------------

Facilities

Free internet		Bring-your-own Wi-Fi router	
Separated bath and toilet	Air conditioning	BS compatible	CATV compatible
Balcony	Sunrooms	Bathroom dryer	Indoors washer
Washbasin	Smart toilet	IH kitchen	Propane gas
Auto-lock	Numeric keypad	CCTV	TV Intercom
Delivery box	Lighting equipment	Roofed bicycle park	Roofed car park

Other facilities

INDUCTION HOB	Lift
---------------	------

Morinosato Branch Global Sales
Department

金沢市もりの里2丁目21番地 0120-36-3335
免許番号 石川県知事(6)第3529号
手数料負担: 貸主0% 借主100% 手数料配分: 元付50% 客付50%

