



Monthly rent

Rent	46,000円	Security deposit	—
Common fees		Key money	—
Management fees	3,000円		
Parking fee	空き区画なし	Restoration fee	50,000円
Fixed water fee	実費	Brokerage fee	家賃＋駐車料の1か月（税別）
Town fee	—	Key setting fee	11,000円
Mamex membership fee	2,970円	Internet	—
Other	—	Mamex Admission fee	13,200円
		Other	—

Property description

Location	金沢市もりの里2丁目147番地		
Transport	北鉄バス 若松橋バス停/徒歩3分		
Property type	マンション	Number of Rooms	48室
Structure	鉄骨造地上6階建		
Date of completion	2005年2月		
Fire insurance	Included in Mamex Members Club		
Guarantor company	Included in Mamex Members Club		
Property category	Managed properties		
Type of transaction	Agency		

GARBAGE — ON SITE / — / — ACCESS / — BOX / CORNER ROOM / P: ROOFLESS 5,500 YEN (TAX INCLUDED) / P: WITH ROOF 6,600 YEN (TAX INCLUDED)

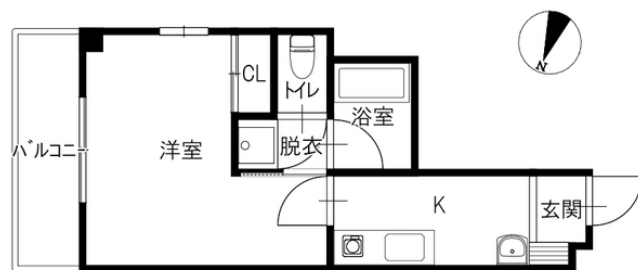

Room layout

洋8.2 K2.8（専有面積：25.4㎡）

Rental condition

Students only	Women only	Foreigner friendly	Children Allowed
Single Apartment	Pets allowed	Available for spring move-in	Reservations available before acceptance

Facilities

Free internet		Bring-your-own Wi-Fi router	
Separated bath and toilet	Air conditioning	BS compatible	CATV compatible
Balcony	Sunrooms	Bathroom dryer	Indoors washer
Washbasin	Smart toilet	IH kitchen	Propane gas
Auto-lock	Numeric keypad	CCTV	TV Intercom
Delivery box	Lighting equipment	Roofed bicycle park	Roofed car park

Other facilities

INDUCTION HOB	Lift
---------------	------

Morinosato Branch Global Sales Department

金沢市もりの里2丁目21番地 0120-36-3335

免許番号 石川県知事(6)第3529号

手数料負担: 貸主0% 借主100% 手数料配分: 元付50% 客付50%

