



Monthly rent

| | | | |
|--------------------------------|---------|------------------------|--------------------|
| Rent | 34,000円 | Security deposit | — |
| Common fees Management fees | 2,000円 | Key money | — |
| Parking fee | — | Restoration fee | 50,000円 |
| Fixed water fee | 実費 | Brokerage fee | 家賃＋駐車料の 1か月（税別） |
| Town fee | 300円 | Key setting fee | 16,500円 |
| Mamex membership fee | 2,970円 | Internet | — |
| Other | — | Mamex Admission fee | 13,200円 |

Initial costs

Other

Property description

| | | | |
|---------------------|--------------------------------|-----------------|-----|
| Location | 金沢市旭町3丁目17番22号 | | |
| Transport | 北鉄バス 旭町バス停/徒歩3分 | | |
| Property type | アパート | Number of Rooms | 12室 |
| Structure | 軽量鉄骨造地上2階建 | | |
| Date of completion | 1982年1月 | | |
| Fire insurance | Included in Mamex Members Club | | |
| Guarantor company | Included in Mamex Members Club | | |
| Property category | Managed properties | | |
| Type of transaction | Agency | | |

More than 2 stove tops / Internet Fibre-optic / Roomsinside drying / corner room / FURNISHED ROOM(TV / WASHING MACHINE / REFRIGERATOR / MICROWAVE / BED / TV STAND / RO —TE —BULL / RACK)

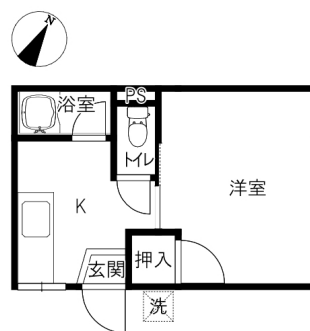

Room layout

洋6.1 K3（専有面積：19.58㎡）

Rental condition

| | | | |
|------------------|--------------|--------------------|------------------|
| Students only | Women only | Foreigner friendly | Children Allowed |
| Single Apartment | Pets allowed | | |

Facilities

| Free internet | | Bring-your-own Wi-Fi router | |
|---------------------------|--------------------|-----------------------------|-------------------------|
| Separated bath and toilet | Air conditioning | BS compatible | CATV compatible |
| Balcony | Sunrooms | Bathroom dryer | Washing machine outdoor |
| Washbasin | Smart toilet | Gas & IH kitchen | Propane gas |
| Auto-lock | Card key | CCTV | TV Intercom |
| Delivery box | Lighting equipment | Roofed bicycle park | Car park |

Other facilities

INDUCTION HOB

Morinosato Branch Global Sales
Department

金沢市もりの里2丁目21番地 0120-36-3335

免許番号 石川県知事(6)第3529号

手数料負担: 貸主0% 借主100% 手数料配分: 元付50% 客付50%

