

## マリエ B002

2026/ 3/ 28~Move-in ready



Property detail



## Monthly rent

Rent	36,000円
Common fees	2,000円
Management fees	
Parking fee	4,400円/1台
Fixed water fee	実費
Town fee	300円
Mamex membership fee	3,300円
Other	—

## Initial costs

Security deposit	—
Key money	10,000円
Restoration fee	50,000円
Brokerage fee	家賃+駐車料の1か月(税別)
Key setting fee	19,800円
Internet	11,000円
Mamex Admission fee	24,200円

Other

—

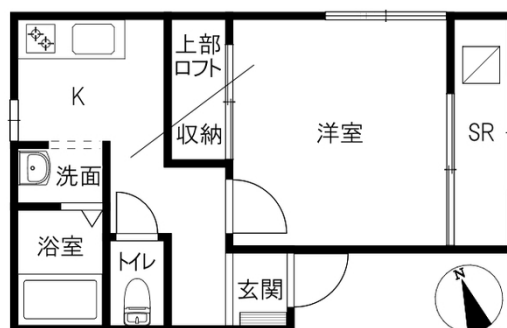

## Room layout

洋6.7 K3 ロフト (専有面積: 30.54㎡)

## Property description

Location	金沢市鈴見台2丁目25番11号		
Transport	北鉄バス 若谷バス停/徒歩4分		
Property type	アパート	Number of Rooms	8室
Structure	木造地上2階建		
Date of completion	1994年3月		
Fire insurance	Included in Mamex Members Club		
Guarantor company	Included in Mamex Members Club		
Property category	Managed properties		
Type of transaction	Agency		

More than 2 burners on stove/Inter —net optical/sh —zbox/corner room/light car only

## Rental condition

Students only	Women only	Foreigner friendly	Children Allowed
Single Apartment	Pets allowed	Available for spring move-in	Reservations available before acceptance

## Facilities

Free internet		Wi-Fi — included	
Separated bath and toilet	Air conditioning	BS compatible	CATV compatible
Balcony	Sunrooms	Bathroom dryer	Indoors washer
Washbasin	Smart toilet	Gas & IH kitchen	Propane gas
Auto-lock	Card key	CCTV	TV Intercom
Delivery box	Lighting equipment	Roofed bicycle park	Car park

## Other facilities

INDUCTION HOB

Morinosato Branch Global Sales  
Department

金沢市もりの里2丁目21番地 0120-36-3335

免許番号 石川県知事(6)第3529号

手数料負担: 貸主0% 借主100% 手数料配分: 元付50% 客付50%



のうか不動産  
NOKA REAL ESTATE