



Monthly rent

Rent	38,000円	Security deposit	—
Common fees		Key money	38,000円
Management fees	2,000円	Restoration fee	60,000円
Parking fee	3,300円／1台	Brokerage fee	家賃＋駐車料の1か月（税別）
Fixed water fee	実費	Key setting fee	16,500円
Town fee	200円	Internet	11,000円
Mamex membership fee	2,970円	Mamex Admission fee	13,200円
Other	—		

Initial costs

Other —

Property description

Location	金沢市田上1丁目100番地		
Transport	北鉄バス 田上新町バス停/徒歩3分		
Property type	アパート	Number of Rooms	6室
Structure	軽量鉄骨造地上2階建		
Date of completion	1985年1月		
Fire insurance	Included in Mamex Members Club		
Guarantor company	Included in Mamex Members Club		
Property category	Managed properties		
Type of transaction	Agency		

More than 2 burners on stove/Internet Fibre-optic/ Corner room/ Top floor

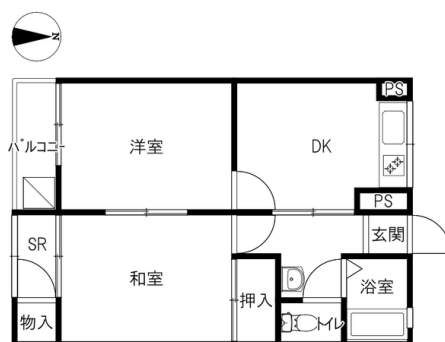

Room layout

和6 洋6 DK6（専有面積：42.23㎡）

Rental condition

Students only	Women only	Foreigner friendly	Children Allowed
2 people allowed	Pets allowed		

Facilities

Free internet		Wi-Fi — included	
Separated bath and toilet	Air conditioning	BS compatible	CATV compatible
Balcony	Sunrooms	Bathroom dryer	Washing machine outdoor
Independent washbasin	Smart toilet	Gas kitchen	Propane gas
Auto-lock	Card key	CCTV	TV Intercom
Delivery box	Lighting equipment	Roofed bicycle park	Car park

Other facilities

Carry-on stove

Morinosato Branch Global Sales Department

金沢市もりの里2丁目21番地 0120-36-3335

免許番号 石川県知事(6)第3529号

手数料負担:貸主0% 借主100% 手数料配分:元付50% 客付50%

