

Montpellier 0102

2025/ 1/ 20~Move-in ready



Property detail



写真準備中

Monthly rent

Rent	52,000円
Common fees Management fees	2,000円
Parking fee	6,050円/1台
Fixed water fee	実費
Town fee	300円
Mamex membership fee	Student: 2,970円 Worker: 2,090円
Other	—

Initial costs

Security deposit	—
Key money	104,000円
Restoration fee	55,000円
Brokerage fee	家賃+駐車料の 1か月 (税別)
Key setting fee	16,500円
Internet	11,000円
Mamex Admission fee	Student: 13,200円 Worker: 11,000円
Other	—

Property description

Location	金沢市天神町1丁目14番3号		
Transport	北鉄バス 田井町バス停/徒歩1分		
Property type	アパート	Number of Rooms	8室
Structure	木造地上2階建		
Date of completion	2012年2月		
Fire insurance	Included in Mamex Members Club		
Guarantor company	Included in Mamex Members Club		
Property category	Managed properties		
Type of transaction	Agency		

Over 2 burners stove/Kitchen facing each other/Internet Fibre-optic —Kitchen/Internet Fibre-optic/Box/ Corner room —

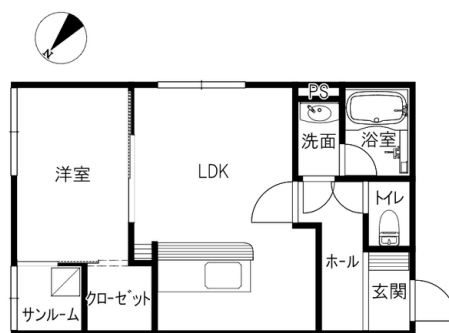

Room layout 洋4.8 LDK9.5 (専有面積: 37.53㎡)

Rental condition

Students only	Male / Female	Foreigner friendly	Children Allowed
Single Apartment	Pets allowed	Available for spring move-in	Reservations available before acceptance

Facilities

Free internet		Bring-your-own Wi-Fi router	
Separated bath and toilet	Air conditioning & heating	BS compatible	CATV compatible
Balcony	Sunrooms	Bathroom dryer/heater	Indoors washer
Washbasin	Smart toilet	Gas & IH kitchen	Propane gas
Auto-lock	Card key	CCTV	TV Intercom
Delivery box	Lighting equipment	Roofed bicycle park	Car park

Other facilities

INDUCTION HOB

Morinosato Branch Global Sales Department

金沢市もりの里2丁目21番地 0120-36-3335
免許番号 石川県知事(6)第3529号
手数料負担: 貸主0% 借主100% 手数料配分: 元付50% 客付50%

 のうか不動産
 NOKA REAL ESTATE