

JANDY鈴見台 0103

Ready to move in



Property detail



Monthly rent

Rent	34,000円
Common fees Management fees	2,000円
Parking fee	無料/1台
Fixed water fee	実費
Town fee	400円
Mamex membership fee	Student: 2,970円 Worker: 2,090円
Other	—

Initial costs

Security deposit	—
Key money	—
Restoration fee	50,000円
Brokerage fee	家賃+駐車料の 1か月 (税別)
Key setting fee	16,500円
Internet	11,000円
Mamex Admission fee	Student: 13,200円 Worker: 11,000円
Other	—

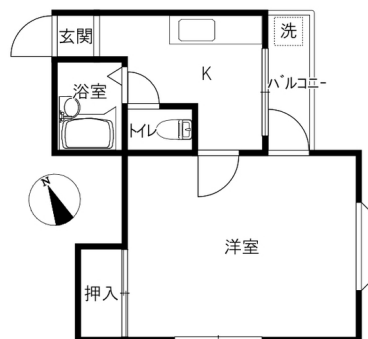

Room layout 洋10 K4

Exclusive area 29.39㎡

Rental condition

Students only	Male / Female	Foreigner friendly	Children Allowed	Single Apartment	Pets allowed
---------------	---------------	--------------------	------------------	------------------	--------------

Facilities

Free internet		Bring-your-own Wi-Fi router	
Separated bath and toilet	Air conditioning	BS compatible	CATV compatible
Balcony	Sunrooms	Bathroom dryer	Washing machine outdoor
Washbasin In bathroom	Smart toilet	Gas & IH kitchen	City gas
Auto-lock	Card key	CCTV	TV Intercom
Delivery box	Lighting equipment	Roofed bicycle park	Car park

Other facilities

INDUCTION HOB

Property description

Location	金沢市鈴見台3丁目10番14号		
Transport	北鉄バス 鈴見台二丁目バス停/徒歩5分		
Property type	アパート	Number of Rooms	8室
Structure	木造地上2階建		
Date of completion	1991年1月		
Fire insurance	Included in Mamex Members Club		
Guarantor company	Included in Mamex Members Club		
Property category	Managed properties		
Type of transaction	Agency		

More than 2 stove tops / Internet Fibre-optic / Corner room

Morinosato Branch Global Sales Department

金沢市もりの里2丁目21番地 0120-36-3335
 免許番号 石川県知事(6)第3529号
 手数料負担: 貸主0% 借主100% 手数料配分: 元付50% 客付50%

