



Monthly rent

| | | | |
|----------------------|--------|---------------------|---------|
| Rent | — | Security deposit | — |
| Common fees | — | Key money | — |
| Management fees | — | | — |
| Parking fee | — | Restoration fee | — |
| Fixed water fee | — | Brokerage fee | — |
| Town fee | — | Key setting fee | — |
| Mamex membership fee | 2,970円 | Internet | — |
| Other | — | Mamex Admission fee | 13,200円 |
| | | Other | — |

Initial costs

Property description

| | | | |
|---------------------|--------------------------------|-----------------|-----|
| Location | 金沢市小立野4丁目9番15号 | | |
| Transport | 北鉄バス 小立野3丁目バス停/徒歩3分 | | |
| Property type | アパート | Number of Rooms | 10室 |
| Structure | 木造地上2階建 | | |
| Date of completion | 1990年3月 | | |
| Fire insurance | Included in Mamex Members Club | | |
| Guarantor company | Included in Mamex Members Club | | |
| Property category | Managed properties | | |
| Type of transaction | Agency | | |

On-site garbage station/ 2 or more stove tops / Internet Fibre-optic / ShoesBoxes / FURNISHED ROOM(TV/WASHING MACHINE/REFRIGERATOR/MICROWAVE/BED/TV STAND/RO —TE —BULL/RACK BS NON-COMPATIBLE)

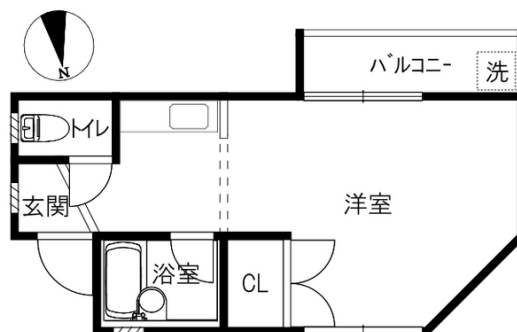

Room layout

洋9 (専有面積: 21.2㎡)

Rental condition

| | | | |
|------------------|--------------|--------------------|------------------|
| Students only | Women only | Foreigner friendly | Children Allowed |
| Single Apartment | Pets allowed | | |

Facilities

| | | | |
|---------------------------|--------------------|---------------------|-------------------------|
| Free internet | | Wi-Fi — included | |
| Separated bath and toilet | Air conditioning | BS/CS support | CATV compatible |
| Balcony | Sunrooms | Bathroom dryer | Washing machine outdoor |
| Washbasin In bathroom | Smart toilet | Gas & IH kitchen | Propane gas |
| Auto-lock | Card key | CCTV | TV Intercom |
| Delivery box | Lighting equipment | Roofed bicycle park | Car park |

Other facilities

| | |
|----------------|--|
| Carry-on stove | |
|----------------|--|

Morinosato Branch Global Sales Department

金沢市もりの里2丁目21番地 0120-36-3335

免許番号 石川県知事(6)第3529号

手数料負担: 貸主0% 借主100% 手数料配分: 元付50% 客付50%

のうか不動産
NOKA REAL ESTATE