

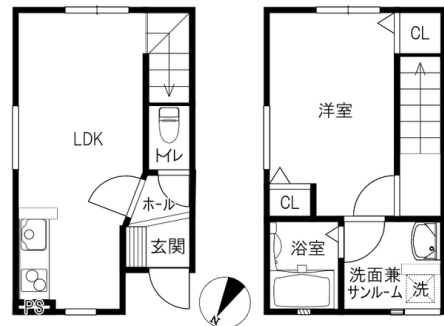

## Monthly rent

Rent	—	Security deposit	—
Common fees Management fees	—	Key money	—
Parking fee	—	Restoration fee	—
Fixed water fee	—	Brokerage fee	—
Town fee	—	Key setting fee	—
Mamex membership fee	3,300円	Internet	—
Other	—	Mamex Admission fee	24,200円
		Other	—

## Initial costs



## Room layout

2階 洋6/1階 LDK8.6 (専有面積: 40.01㎡)

## Rental condition

Students only	Women only	Foreigner friendly	Children Allowed
2 people allowed	Pets allowed		

## Property description

Location	金沢市鈴見町郡家山29番地		
Transport	北鉄バス 若谷バス停/徒歩3分		
Property type	テラスハウス	Number of Rooms	4室
Structure	木造地上2階建		
Date of completion	2015年10月		
Fire insurance	Included in Mamex Members Club		
Guarantor company	Included in Mamex Members Club		
Property category	Managed properties		
Type of transaction	Agency		

## Facilities

Free internet		Wi-Fi — included	
Separated bath and toilet	Air conditioning	BS/CS support	CATV compatible
Balcony	Sunrooms	Bathroom dryer/heater	Indoors washer
Independent washbasin	Smart toilet	IH kitchen	Propane gas
Auto-lock	Card key	CCTV	TV Intercom
Delivery box	Lighting equipment	Roofed bicycle park	Car park

## Other facilities

INDUCTION HOB	Reheating function
---------------	--------------------

Morinosato Branch Global Sales Department

金沢市もりの里2丁目21番地 0120-36-3335  
 免許番号 石川県知事(6)第3529号  
 手数料負担: 貸主0% 借主100% 手数料配分: 元付50% 客付50%



2 or more burners / Open-concept kitchen / — / — / — / Corner unit / Top floor / Water purifier not allowed / 2 air conditioners