



写真準備中

## Monthly rent

|                                |         |
|--------------------------------|---------|
| Rent                           | 32,000円 |
| Common fees<br>Management fees | 2,000円  |
| Parking fee                    | 空き区画なし  |
| Fixed water fee                | 実費      |
| Town fee                       | 200円    |
| Mamex<br>membership fee        | 2,970円  |
| Other                          | —       |

## Initial costs

|                        |                    |
|------------------------|--------------------|
| Security deposit       | —                  |
| Key money              | —                  |
| Restoration fee        | 50,000円            |
| Brokerage fee          | 家賃＋駐車料の<br>1か月（税別） |
| Key setting fee        | 16,500円            |
| Internet               | —                  |
| Mamex<br>Admission fee | 13,200円            |
| Other                  | —                  |

## Property description

|                     |                                |                 |    |
|---------------------|--------------------------------|-----------------|----|
| Location            | 金沢市錦町2の38-4                    |                 |    |
| Transport           | 北鉄バス 錦町バス停/徒歩3分                |                 |    |
| Property type       | アパート                           | Number of Rooms | 6室 |
| Structure           | 木造地上2階建                        |                 |    |
| Date of completion  | 1990年12月                       |                 |    |
| Fire insurance      | Included in Mamex Members Club |                 |    |
| Guarantor company   | Included in Mamex Members Club |                 |    |
| Property category   | Managed properties             |                 |    |
| Type of transaction | Agency                         |                 |    |

More than 2 burners on stove/Internet Fibre-optic/ Corner room/  
Top floor

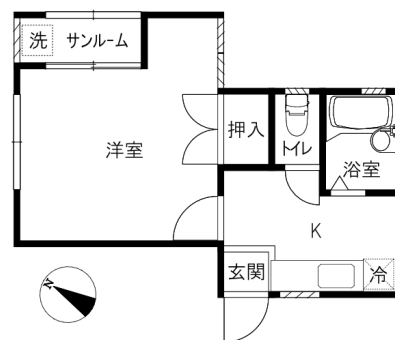

Room layout 洋7.7 K3（専有面積：24㎡）

## Rental condition

|                  |              |                    |                  |
|------------------|--------------|--------------------|------------------|
| Students only    | Women only   | Foreigner friendly | Children Allowed |
| Single Apartment | Pets allowed |                    |                  |

## Facilities

| Free internet             |                    | Bring-your-own Wi-Fi router |                 |
|---------------------------|--------------------|-----------------------------|-----------------|
| Separated bath and toilet | Air conditioning   | BS compatible               | CATV compatible |
| Balcony                   | Sunrooms           | Bathroom dryer              | Indoors washer  |
| Washbasin In bathroom     | Smart toilet       | Gas kitchen                 | Propane gas     |
| Auto-lock                 | Card key           | CCTV                        | TV Intercom     |
| Delivery box              | Lighting equipment | Roofed bicycle park         | Car park        |

## Other facilities

|                |
|----------------|
| Carry-on stove |
|----------------|

Morinosato Branch Global Sales  
Department

金沢市もりの里2丁目21番地 0120-36-3335

免許番号 石川県知事(6)第3529号

手数料負担:貸主0% 借主100% 手数料配分:元付50% 客付50%

