

こーぼ21 0202

Ready to move in



Property detail



写真準備中

## Monthly rent

|                      |         |
|----------------------|---------|
| Rent                 | 36,000円 |
| Common fees          | —       |
| Management fees      | —       |
| Parking fee          | —       |
| Fixed water fee      | 実費      |
| Town fee             | —       |
| Mamex membership fee | 3,300円  |
| Other                | —       |

## Initial costs

|                     |                |
|---------------------|----------------|
| Security deposit    | —              |
| Key money           | —              |
| Restoration fee     | 55,000円        |
| Brokerage fee       | 家賃+駐車料の1か月(税別) |
| Key setting fee     | 19,800円        |
| Internet            | —              |
| Mamex Admission fee | 24,200円        |
| Other               | —              |

## Property description

|                     |                                |                 |    |
|---------------------|--------------------------------|-----------------|----|
| Location            | 金沢市天神町2丁目1番32号                 |                 |    |
| Transport           | 北鉄バス 如来寺前バス停/徒歩6分              |                 |    |
| Property type       | テラスハウス                         | Number of Rooms | 3室 |
| Structure           | 木造地上2階建                        |                 |    |
| Date of completion  | 1986年11月                       |                 |    |
| Fire insurance      | Included in Mamex Members Club |                 |    |
| Guarantor company   | Included in Mamex Members Club |                 |    |
| Property category   | Managed properties             |                 |    |
| Type of transaction | Agency                         |                 |    |

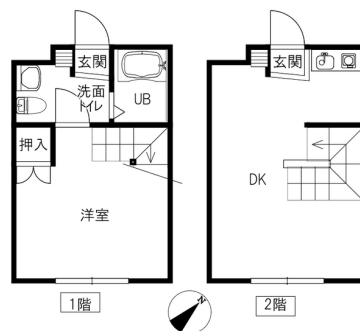

Room layout 1階 洋7.5/2階 LDK10 (専有面積: 39.09㎡)

## Rental condition

|                  |              |                    |                  |
|------------------|--------------|--------------------|------------------|
| Students only    | Women only   | Foreigner friendly | Children Allowed |
| Single Apartment | Pets allowed |                    |                  |

## Facilities

|                           |                    |                     |                         |
|---------------------------|--------------------|---------------------|-------------------------|
| Free internet             | Wi-Fi routers      |                     |                         |
| Separated bath and toilet | Air conditioning   | BS compatible       | CATV compatible         |
| Balcony                   | Sunrooms           | Bathroom dryer      | Washing machine outdoor |
| Independent washbasin     | heated toilet seat | IH kitchen          | Propane gas             |
| Auto-lock                 | Card key           | CCTV                | TV Intercom             |
| Delivery box              | Lighting equipment | Roofed bicycle park | Car park                |

## Other facilities

INDUCTION HOB

Morinosato Branch Global Sales Department

金沢市もりの里2丁目21番地 0120-36-3335  
 免許番号 石川県知事(6)第3529号  
 手数料負担: 貸主0% 借主100% 手数料配分: 元付50% 客付50%

のうか不動産  
NOKA REAL ESTATE