

## バナナハウス 0103

2025/ 3/ 28~Move-in ready



Property detail



写真準備中

## Monthly rent

|                                |           |
|--------------------------------|-----------|
| Rent                           | 31,000円   |
| Common fees<br>Management fees | 3,000円    |
| Parking fee                    | 3,300円/1台 |
| Fixed water fee                | 実費        |
| Town fee                       | 500円      |
| Mamex membership fee           | 2,970円    |
| Other                          | —         |

## Initial costs

|                     |                |
|---------------------|----------------|
| Security deposit    | —              |
| Key money           | —              |
| Restoration fee     | 50,000円        |
| Brokerage fee       | 家賃+駐車料の1か月(税別) |
| Key setting fee     | 16,500円        |
| Internet            | 11,000円        |
| Mamex Admission fee | 13,200円        |
| Other               | —              |

## Property description

|                     |                                |                 |    |
|---------------------|--------------------------------|-----------------|----|
| Location            | 金沢市鈴見台2丁目3番10号                 |                 |    |
| Transport           | 北鉄バス 鈴見台二丁目バス停/徒歩2分            |                 |    |
| Property type       | アパート                           | Number of Rooms | 8室 |
| Structure           | 木造地上2階建                        |                 |    |
| Date of completion  | 1993年2月                        |                 |    |
| Fire insurance      | Included in Mamex Members Club |                 |    |
| Guarantor company   | Included in Mamex Members Club |                 |    |
| Property category   | Managed properties             |                 |    |
| Type of transaction | Agency                         |                 |    |

More than 2 burners on stove/Internet Fibre-optic/ShoesBox/Corner room

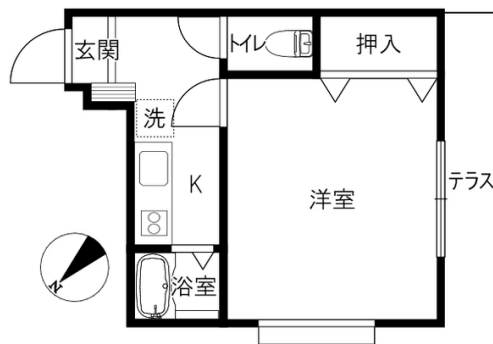

Room layout 洋7 K2.8 (専有面積: 21.74㎡)

## Rental condition

|                  |               |                              |  |
|------------------|---------------|------------------------------|--|
| Students only    | Male / Female | Foreigner friendly           | Children Allowed                         |
| Single Apartment | Pets allowed  | Available for spring move-in | Reservations available before acceptance |

## Facilities

|                           |                    |                             |                 |
|---------------------------|--------------------|-----------------------------|-----------------|
| Free internet             |                    | Bring-your-own Wi-Fi router |                 |
| Separated bath and toilet | Air conditioning   | BS compatible               | CATV compatible |
| Balcony                   | Sunrooms           | Bathroom dryer              | Indoors washer  |
| Washbasin                 | Smart toilet       | IH kitchen                  | Propane gas     |
| Auto-lock                 | Card key           | CCTV                        | TV Intercom     |
| Delivery box              | Lighting equipment | Roofed bicycle park         | Car park        |

## Other facilities

INDUCTION HOB

Morinosato Branch Global Sales Department

金沢市もりの里2丁目21番地 0120-36-3335

免許番号 石川県知事(6)第3529号

手数料負担: 貸主0% 借主100% 手数料配分: 元付50% 客付50%

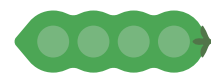
のうか不動産  
NOKA REAL ESTATE