

CIEL 0202

Closed



Property detail



Monthly rent

Rent	—	Security deposit	—
Common fees Management fees	—	Key money	—
Parking fee	—	Restoration fee	—
Fixed water fee	—	Brokerage fee	—
Town fee	—	Key setting fee	—
Mamex membership fee	2,970円	Internet	—
Other	—	Mamex Admission fee	13,200円

Initial costs

Other —

Property description

Location	金沢市若松町3丁目265番地		
Transport	北鉄バス 若谷バス停/徒歩2分		
Property type	アパート	Number of Rooms	8室
Structure	木造地上2階建		
Date of completion	2018年2月		
Fire insurance	Included in Mamex Members Club		
Guarantor company	Included in Mamex Members Club		
Property category	Managed properties		
Type of transaction	Agency		

Over 2 burners stove / System kitchen / Internet Fibre-optic / Walk-in Closet / ShoesBox / Corner room / Top floor / No water purifier

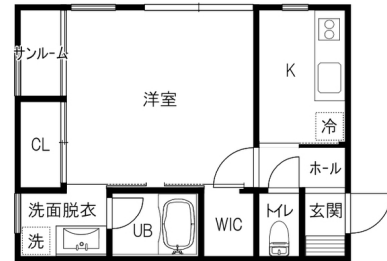

Room layout 洋8.3 K3 (専有面積: 32.64㎡)

Rental condition

Students only	Male / Female	Foreigner friendly	Children Allowed
Single Apartment	Pets allowed	Available for spring move-in	Reservations available before acceptance

Facilities

Free internet		Bring-your-own Wi-Fi router	
Separated bath and toilet	Air conditioning	BS/CS compatible	CATV compatible
Balcony	Sunrooms	Bathroom dryer/heater	Indoors washer
Washbasin	Smart toilet	IH kitchen	Propane gas
Auto-lock	Card key	CCTV	TV Intercom
Delivery box	Lighting equipment	Roofed bicycle park	Car park

Other facilities

INDUCTION HOB

Morinosato Branch Global Sales Department

金沢市もりの里2丁目21番地 0120-36-3335

免許番号 石川県知事(6)第3529号

手数料負担: 貸主0% 借主100% 手数料配分: 元付50% 客付50%

