

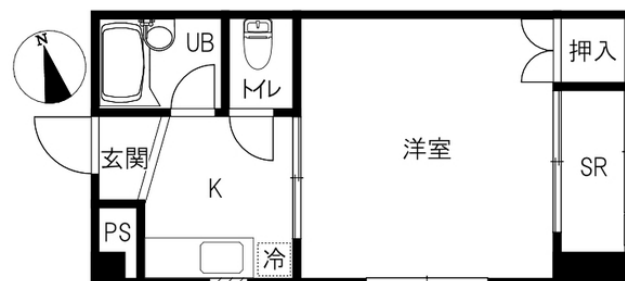

## Monthly rent

Rent	—	Security deposit	—
Common fees	—	Key money	—
Management fees	—		—
Parking fee	—	Restoration fee	—
Fixed water fee	—	Brokerage fee	—
Town fee	—	Key setting fee	—
Mamex membership fee	2,970円	Internet	—
Other	—	Mamex Admission fee	13,200円
		Other	—

## Initial costs



## Room layout

洋8.2 K (専有面積：27㎡)

## Rental condition

Students only	Women only	Foreigner friendly	Children Allowed
Single Apartment	Pets allowed		

## Property description

Location	野々市市扇が丘8番15号		
Transport	北鉄バス 金沢工業大学（四十万）バス停/徒歩1分		
Property type	マンション	Number of Rooms	20室
Structure	鉄骨造地上3階建		
Date of completion	1988年4月		
Fire insurance	Included in Mamex Members Club		
Guarantor company	Included in Mamex Members Club		
Property category	Managed properties		
Type of transaction	Agency		

## Facilities

Free internet		Wi-Fi — included	
Separated bath and toilet	Air conditioning	BS compatible	CATV compatible
Balcony	Sunrooms	Bathroom dryer	Indoors washer
Washbasin In bathroom	Smart toilet	Gas kitchen	Propane gas
Auto-lock	Card key	CCTV	TV Intercom
Delivery box	Lighting equipment	Roofed bicycle park	Car park

## Other facilities

Carry-on stove
----------------

Morinosato Branch Global Sales Department

金沢市もりの里2丁目21番地 0120-36-3335

免許番号 石川県知事(6)第3529号

手数料負担: 貸主0% 借主100% 手数料配分: 元付50% 客付50%



On-site garbage station/ 2 or more stove tops / Internet Fibre-optic / Corner room