

クリスマスM 0103

during move-in



Property detail



Monthly rent

Rent	—	Security deposit	—
Common fees	—	Key money	—
Management fees	—	Restoration fee	—
Parking fee	—	Brokerage fee	—
Fixed water fee	—	Key setting fee	—
Town fee	—	Internet	—
Mamex membership fee	2,970円	Mamex Admission fee	13,200円
Other	—	Other	—

Initial costs

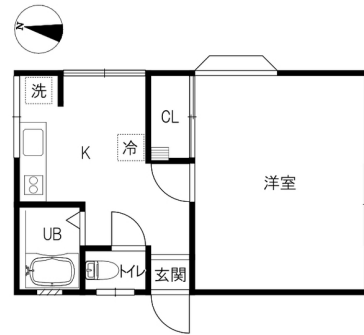

Room layout

洋10 K6.2 (専有面積: 33.12㎡)

Rental condition

Students only	Male / Female	Foreigner friendly	Children Allowed
Single Apartment	Pets allowed	Available for spring move-in	Reservations available before acceptance

Property description

Location	金沢市もりの里1丁目227番地		
Transport	北鉄バス 若松西バス停/徒歩6分		
Property type	アパート	Number of Rooms	6室
Structure	木造地上2階建		
Date of completion	1992年12月		
Fire insurance	Included in Mamex Members Club		
Guarantor company	Included in Mamex Members Club		
Property category	Managed properties		
Type of transaction	Agency		

Facilities

Free internet		Equipped Wi-fi router	
Separated bath and toilet	Air conditioning & heating	BS compatible	CATV compatible
Balcony	Sunrooms	Bathroom dryer	Indoors washer
Washbasin	Smart toilet	Gas & IH kitchen	Propane gas
Auto-lock	Card key	CCTV	TV Intercom
Delivery box	Lighting equipment	Roofed bicycle park	Car park

Other facilities

INDUCTION HOB

Morinosato Branch Global Sales Department

金沢市もりの里2丁目21番地 0120-36-3335

免許番号 石川県知事(6)第3529号

手数料負担: 貸主0% 借主100% 手数料配分: 元付50% 客付50%



のうか不動産
NOKA REAL ESTATE

MORE THAN 2 STOVE TOPS / Internet Fibre-optic / ROOMSINSIDE DRYING / CORNER ROOM / 2 DOOR REFRIGERATOR, MICROWAVE, WASHING MACHINE, TV, KARA 一BOX