

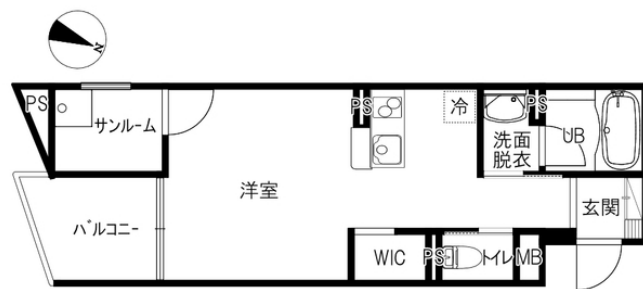

Monthly rent

| | | | |
|----------------------|--------|---------------------|---------|
| Rent | — | Security deposit | — |
| Common fees | — | Key money | — |
| Management fees | — | Restoration fee | — |
| Parking fee | — | Brokerage fee | — |
| Fixed water fee | — | Key setting fee | — |
| Town fee | — | Internet | — |
| Mamex membership fee | 2,970円 | Mamex Admission fee | 13,200円 |
| Other | — | Other | — |

Initial costs



Room layout

洋10.4 K (専有面積: 30.7㎡)

Rental condition

| | | | |
|------------------|--------------|------------------------------|--|
| Students only | Women only | Foreigner friendly | Children Allowed |
| Single Apartment | Pets allowed | Available for spring move-in | Reservations available before acceptance |

Property description

| | | | |
|---------------------|--------------------------------|-----------------|-----|
| Location | 金沢市若松町3丁目231番 | | |
| Transport | 北鉄バス 若谷バス停/徒歩2分 | | |
| Property type | マンション | Number of Rooms | 11室 |
| Structure | 鉄筋コンクリート造地上3階建 | | |
| Date of completion | 2021年2月 | | |
| Fire insurance | Included in Mamex Members Club | | |
| Guarantor company | Included in Mamex Members Club | | |
| Property category | Managed properties | | |
| Type of transaction | Agency | | |

Over 2 burners stove / System kitchen / Internet Fibre-optic / Walk-in Closet / ShoesBox / Corner room / No water purifier

Facilities

| | | | |
|---------------------------|--------------------|-----------------------|-----------------|
| Free internet | | Wi-Fi — included | |
| Separated bath and toilet | Air conditioning | BS/CS support | CATV compatible |
| Balcony | Sunrooms | Bathroom dryer/heater | Indoors washer |
| Washbasin | Smart toilet | IH kitchen | Propane gas |
| Auto-lock | IC KEY | CCTV | TV Intercom |
| Delivery box | Lighting equipment | Roofed bicycle park | Car park |

Other facilities

| | |
|---------------|--------------------|
| INDUCTION HOB | Reheating function |
|---------------|--------------------|

Morinosato Branch Global Sales Department

金沢市もりの里2丁目21番地 0120-36-3335

免許番号 石川県知事(6)第3529号

手数料負担: 貸主0% 借主100% 手数料配分: 元付50% 客付50%

