

ナルワハイム 0101

during move-in



Property detail



写真準備中

Monthly rent

Rent	—	Security deposit	—
Common fees	—	Key money	—
Management fees	—	Restoration fee	—
Parking fee	—	Brokerage fee	—
Fixed water fee	—	Key setting fee	—
Town fee	—	Internet	—
Mamex membership fee	3,300円	Mamex Admission fee	24,200円
Other	—	Other	—

Initial costs

Property description

Location	金沢市鳴和2丁目9番5号		
Transport	北鉄バス 春日町バス停/徒歩5分		
Property type	マンション	Number of Rooms	10室
Structure	鉄骨造地上3階建		
Date of completion	1985年5月		
Fire insurance	Included in Mamex Members Club		
Guarantor company	Included in Mamex Members Club		
Property category	Managed properties		
Type of transaction	Agency		

No water purifiers allowed/no screens installed on windows without screens.

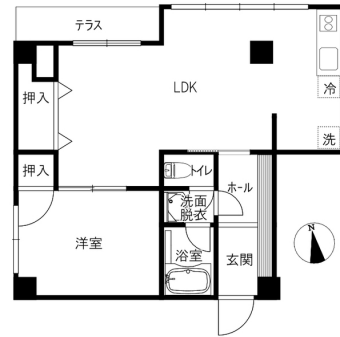

Room layout 洋6 LDK15.7 (専有面積: 48.96㎡)

Rental condition

Students only	Women only	Foreigner friendly	Children Allowed
2 people allowed	Pets allowed		

Facilities

Free internet	Wi-Fi routers		
Separated bath and toilet	Air conditioning	BS compatible	CATV compatible
Terrace	Sunrooms	Bathroom dryer	place for washing machine
Washbasin	Smart toilet	Kitchen	Propane gas
Auto-lock	Card key	CCTV	TV Intercom
Delivery box	Lighting equipment	Roofed bicycle park	Roofed car park

Other facilities

Carry-on stove

Morinosato Branch Global Sales Department

金沢市もりの里2丁目21番地 0120-36-3335
 免許番号 石川県知事(6)第3529号
 手数料負担: 貸主0% 借主100% 手数料配分: 元付50% 客付50%

