

## エスタシオン 0305

2025/ 4/ 4~Move-in ready



Property detail



写真準備中

## Monthly rent

Rent	47,000円
Common fees Management fees	3,000円
Parking fee	4,400円/1台
Fixed water fee	2,750円
Town fee	300円
Mamex membership fee	Student: 2,970円 Worker: 2,090円
Other	—

## Initial costs

Security deposit	—
Key money	47,000円
Restoration fee	50,000円
Brokerage fee	家賃+駐車料の 1か月 (税別)
Key setting fee	16,500円
Internet	11,000円
Mamex Admission fee	Student: 13,200円 Worker: 11,000円

Other

## Property description

Location	金沢市もりの里2丁目224番地		
Transport	北鉄バス 若松橋バス停/徒歩4分		
Property type	マンション	Number of Rooms	21室
Structure	鉄筋コンクリート造地上4階建		
Date of completion	1998年3月		
Fire insurance	Included in Mamex Members Club		
Guarantor company	Included in Mamex Members Club		
Property category	Managed properties		
Type of transaction	Agency		

MOTORCYCLE PARKING/ GARBAGE DISPOSAL ON THE PREMISES —CESSION/  
ELECTRIC WATER HEATER/ Internet Fibre-optic/ ShoesBox/ P-ROOF  
5,500 YEN (TAX INCL.)

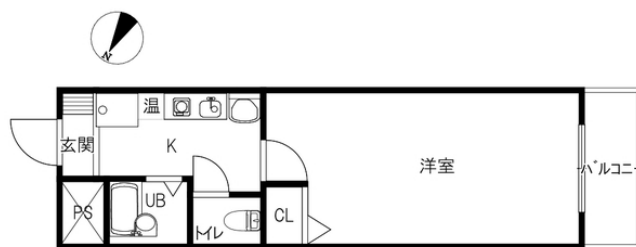

Room layout 洋10.7 K (専有面積: 30㎡)

## Rental condition

Students only	Male / Female	Foreigner friendly	Children Allowed
Single Apartment	Pets allowed	Available for spring move-in	Reservations available before acceptance

## Facilities

Free internet		Bring-your-own Wi-Fi router	
Separated bath and toilet	Air conditioning	BS compatible	CATV compatible
Balcony	Sunrooms	Bathroom dryer	Indoors washer
Independent washbasin	Smart toilet	IH kitchen	All-electric
Auto-lock	Card key	CCTV	TV Intercom
Delivery box	Lighting equipment	Roofed bicycle park	Roofed car park

## Other facilities

INDUCTION HOB

Morinosato Branch Global Sales Department

金沢市もりの里2丁目21番地 0120-36-3335  
免許番号 石川県知事(6)第3529号  
手数料負担: 貸主0% 借主100% 手数料配分: 元付50% 客付50%

のうか不動産  
NOKA REAL ESTATE