



BEL Stella 0203

during move-in



Property detail



Monthly rent

Rent	—	Security deposit	—
Common fees	—	Key money	—
Management fees	—	Restoration fee	—
Parking fee	—	Brokerage fee	—
Fixed water fee	—	Key setting fee	—
Town fee	—	Internet	—
Mamex membership fee	Student: 2,970円 Worker: 2,090円	Mamex Admission fee	Student: 13,200円 Worker: 11,000円
Other	—	Other	—

Initial costs

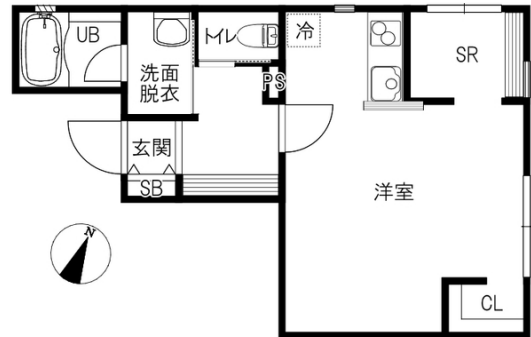

Room layout 洋10.9

Exclusive area 33.38㎡

Rental condition

Students only	Women only	Foreigner friendly	Children Allowed	Single Apartment	Pets allowed
---------------	------------	--------------------	------------------	------------------	--------------

Property description

Location	金沢市若松町3丁目266番地		
Transport	北鉄バス 若谷バス停/徒歩2分		
Property type	アパート	Number of Rooms	6室
Structure	木造地上2階建		
Date of completion	2022年2月		
Fire insurance	Included in Mamex Members Club		
Guarantor company	Included in Mamex Members Club		
Property category	Managed properties		
Type of transaction	Agency		

Facilities

Free internet		Bring-your-own Wi-Fi router	
Separated bath and toilet	Air conditioning	BS/CS compatible	CATV compatible
Balcony	Sunrooms	Bathroom dryer/heater	Indoors washer
Washbasin	Smart toilet	IH kitchen	Propane gas
Auto-lock	IC KEY	CCTV	TV Intercom
Delivery box	Lighting equipment	Roofed bicycle park	Car park

Other facilities

INDUCTION HOB	Reheating function
---------------	--------------------

Morinosato Branch Global Sales Department

金沢市もりの里2丁目21番地 0120-36-3335

免許番号 石川県知事(5)第3529号

手数料負担: 貸主0% 借主100% 手数料配分: 元付50% 客付50%



のうか不動産
NOKA REAL ESTATE

On-site garbage station —Condo w/ 2+ burners/Internet/Inter-Net Optical/Wo —Quinchro —Zed/sh —Zbox/ Corner room/ Top floor/ No water purifier/ Spi w/Bluetooth —Ka —/USB recharge outlet