



Monthly rent

| | |
|--------------------------------|---------|
| Rent | 57,000円 |
| Common fees Management fees | 16,500円 |
| Parking fee | 空き区画なし |
| Fixed water fee | 実費 |
| Town fee | 200円 |
| Mamex membership fee | 2,970円 |
| Other | 30,800円 |

Initial costs

| | |
|------------------------|--------------------|
| Security deposit | — |
| Key money | — |
| Restoration fee | 57,000円 |
| Brokerage fee | 家賃＋駐車料の 1か月（税別） |
| Key setting fee | 19,800円 |
| Internet | 11,000円 |
| Mamex Admission fee | 13,200円 |
| Other | 130,000円 |

Property description

| | | | |
|---------------------|--------------------------------|-----------------|-----|
| Location | 金沢市田上さくら2丁目56番地 | | |
| Transport | 北鉄バス 山環田上バス停/徒歩4分 | | |
| Property type | マンション | Number of Rooms | 50室 |
| Structure | 軽量鉄骨造地上3階建 | | |
| Date of completion | 2024年2月 | | |
| Fire insurance | Included in Mamex Members Club | | |
| Guarantor company | Included in Mamex Members Club | | |
| Property category | Managed properties | | |
| Type of transaction | Agency | | |

Garbage — the premises / — access / — box / No water purifier / Furniture and appliances provided (bed / desk / chair / TV — / washing machine / refrigerator / microwave oven) / Smoking is prohibited in this property. / One-year contract is not available / There is a penalty of one month's rent if the contract is terminated in April or May / Meals will be provided for breakfast and dinner approximately 240 days per year, excluding Saturdays, Sundays, national holidays, and year-end and New Year's holidays.

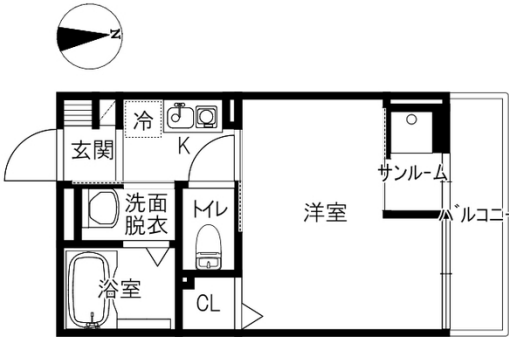

Room layout

洋6（専有面積：21.74㎡）

Rental condition

| | | | |
|------------------|--------------|--------------------|------------------|
| Students only | Women only | Foreigner friendly | Children Allowed |
| Single Apartment | Pets allowed | | |

Facilities

| | | | |
|---------------------------|--------------------|---------------------|-----------------|
| Free internet | | Wi-Fi — included | |
| Separated bath and toilet | Air conditioning | BS/CS support | CATV compatible |
| Balcony | Sunrooms | Bathroom dryer | Indoors washer |
| Washbasin | Smart toilet | IH kitchen | Propane gas |
| Auto-lock | IC KEY | CCTV | TV Intercom |
| Delivery box | Lighting equipment | Roofed bicycle park | Car park |

Other facilities

INDUCTION HOB

Morinosato Branch Global Sales
Department

金沢市もりの里2丁目21番地 0120-36-3335
免許番号 石川県知事(6)第3529号
手数料負担: 貸主0% 借主100% 手数料配分: 元付50% 客付50%

