

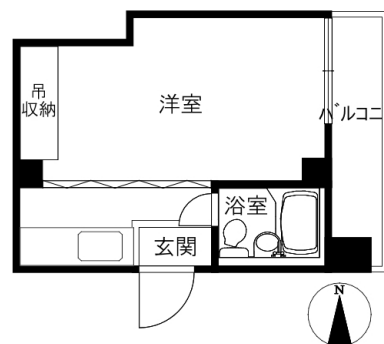

## Monthly rent

|                      |            |                     |                |
|----------------------|------------|---------------------|----------------|
| Rent                 | 27,000円    | Security deposit    | 54,000円        |
| Common fees          |            | Key money           | —              |
| Management fees      | 3,000円     | Restoration fee     | —              |
| Parking fee          | 15,400円／1台 | Brokerage fee       | 家賃＋駐車料の1か月（税別） |
| Fixed water fee      | 実費         | Key setting fee     | —              |
| Town fee             | —          | Internet            | —              |
| Mamex membership fee | —          | Mamex Admission fee | —              |
| Other                | —          | Other               | —              |

## Initial costs



## Room layout

洋7（専有面積：20㎡）

## Rental condition

|                  |              |                              |  |
|------------------|--------------|------------------------------|--|
| Students only    | Women only   | Foreigner friendly           | Children Allowed                         |
| Single Apartment | Pets allowed | Available for spring move-in | Reservations available before acceptance |

## Facilities

| Free internet         |                    | Wi-Fi routers       |                         |
|-----------------------|--------------------|---------------------|-------------------------|
| Unit bath             | Air conditioning   | BS compatible       | CATV compatible         |
| Balcony               | Sunrooms           | Bathroom dryer      | Washing machine outdoor |
| Washbasin In bathroom | Smart toilet       | Gas kitchen         | City gas                |
| Auto-lock             | Card key           | CCTV                | TV Intercom             |
| Delivery box          | Lighting equipment | Roofed bicycle park | Car park                |

## Other facilities

Carry-on stove

## Property description

|                     |                      |                 |    |
|---------------------|----------------------|-----------------|----|
| Location            | 金沢市北安江2丁目16-2        |                 |    |
| Transport           | JR北陸新幹線 金沢駅/徒歩12分    |                 |    |
| Property type       | マンション                | Number of Rooms | 5室 |
| Structure           | 鉄骨造地上3階建             |                 |    |
| Date of completion  | 1984年5月              |                 |    |
| Fire insurance      | Required(Separated)  |                 |    |
| Guarantor company   | Required             |                 |    |
| Property category   | Brokerage properties |                 |    |
| Type of transaction | 一般媒介                 |                 |    |

浄水器不可／暮らすコンシェルジュ+M加入金25,300円（税込I）、月額会費3,993円（税込）※火災保険料は暮らすコンシェルジュPrime+含む／法人契約：暮らすコンシェルジュLight+M（2,090円/月額）、暮らすコンシェルジュ+M加入金（19,800円/税込み、初回のみ）必須/更新事務手数料家賃1か月+消費税／外国籍の方がご入居可能（法人契約または個人契約の場合は保証会社必須）

Morinosato Branch Global Sales Department

金沢市もりの里2丁目21番地 0120-36-3335

免許番号 石川県知事(6)第3529号

手数料負担:貸主0% 借主100% 手数料配分:元付50% 客付50%

